

SHEET: 01 OF 01
 DATE: 10/15/2021
 PROJECT: PERFORMING ARTS CENTER ADA AND PARKING IMPROVEMENTS
 DRAWING NO.: 2021-001
 SCALE: 1" = 200'
 DRAWN BY: J. BROWN
 CHECKED BY: J. BROWN
 APPROVED BY: J. BROWN

GENERAL NOTES

- PROPERTY AND TOPOGRAPHIC INFORMATION IS COMPILED FROM A MAP TITLED "TOPOGRAPHIC PLAN, PREPARED FOR TOWN OF SIMSBURY, IRON HORSE BOULEVARD, SIMSBURY, CONNECTICUT", SCALE: 1"=30', DATE: OCTOBER 16, 2020, PREPARED BY: DENNO LAND SURVEYING & CONSULTING LLC.
- NORTH ARROW, BEARINGS AND COORDINATES ARE BASED UPON THE CONNECTICUT COORDINATE SYSTEM (NAD 1983). ELEVATIONS, CONTOURS AND BENCH MARK ARE BASED UPON (NAVD 1988)
- INFORMATION REGARDING THE LOCATION OF EXISTING UTILITIES HAS BEEN BASED UPON AVAILABLE INFORMATION AND MAY BE INCOMPLETE, AND WHERE SHOWN SHOULD BE CONSIDERED APPROXIMATE. THE LOCATION OF ALL EXISTING UTILITIES SHOULD BE CONFIRMED PRIOR TO BEGINNING CONSTRUCTION. CALL "CALL BEFORE YOU DIG", 1-800-922-4455. ALL UTILITY LOCATIONS THAT DO NOT MATCH THE VERTICAL OR HORIZONTAL CONTROL SHOWN ON THE PLANS SHALL IMMEDIATELY BE BROUGHT TO THE ATTENTION OF THE ENGINEER FOR RESOLUTION.
- SLR INTERNATIONAL, INC. ACCEPTS NO RESPONSIBILITY FOR THE ACCURACY OF MAPS AND DATA WHICH HAVE BEEN SUPPLIED BY OTHERS.
- ALL UTILITY SERVICES ARE TO BE UNDERGROUND. THE EXACT LOCATION, MEANS OF CONSTRUCTION, AND SIZE OF ELECTRIC, TELEPHONE, AND CABLE TELEVISION ARE TO BE DETERMINED BY THE RESPECTIVE UTILITY COMPANIES.
- ALL DIMENSIONS AND ELEVATIONS SHALL BE VERIFIED IN THE FIELD PRIOR TO CONSTRUCTION. ANY DISCREPANCIES SHALL BE BROUGHT TO THE ATTENTION OF THE ENGINEER.
- SEDIMENT AND EROSION CONTROL MEASURES AS DEPICTED ON THESE PLANS AND DESCRIBED WITHIN THE SEDIMENT AND EROSION CONTROL NARRATIVE SHALL BE IMPLEMENTED AND MAINTAINED UNTIL PERMANENT COVER AND STABILIZATION IS ESTABLISHED. ALL SEDIMENT AND EROSION CONTROL MEASURES SHALL CONFORM TO THE "GUIDELINES FOR SOIL EROSION AND SEDIMENT CONTROL", CONNECTICUT - 2002, AND IN ALL CASES BEST MANAGEMENT PRACTICES SHALL PREVAIL.
- ALL DISTURBED AREAS SHALL RECEIVE A MINIMUM OF 6" TOPSOIL, AND BE SEEDED WITH GRASS, AS SHOWN ON THE PLANS.
- ALL PROPOSED CONTOURS AND SPOT ELEVATIONS INDICATE FINISHED GRADE.
- ALL CONSTRUCTION MATERIALS AND METHODS SHALL CONFORM TO THE TOWN OF SIMSBURY REQUIREMENTS AND TO THE APPLICABLE SECTIONS OF THE STATE OF CONNECTICUT DEPARTMENT OF TRANSPORTATION STANDARD SPECIFICATIONS FOR ROADS, BRIDGES, AND INCIDENTAL CONSTRUCTION, FORM 818 AND ADDENDUMS.
- THE PLANS REQUIRE A CONTRACTOR'S WORKING KNOWLEDGE OF LOCAL, MUNICIPAL, WATER AUTHORITY, AND STATE CODES FOR UTILITY SYSTEMS. ANY CONFLICTS BETWEEN MATERIALS AND LOCATIONS SHOWN, AND LOCAL REQUIREMENTS SHALL BE BROUGHT TO THE ATTENTION OF THE ENGINEER PRIOR TO THE EXECUTION OF WORK. THE ENGINEER WILL NOT BE HELD LIABLE FOR COSTS INCURRED TO IMPLEMENT OR CORRECT WORK WHICH DOES NOT CONFORM TO LOCAL CODE.
- ALL FUEL, OIL, PAINT, OR OTHER HAZARDOUS MATERIALS USED DURING CONSTRUCTION SHOULD BE STORED IN A SECONDARY CONTAINER AND REMOVED TO A LOCKED INDOOR AREA WITH AN IMPERVIOUS FLOOR DURING NON-WORK HOURS.
- COMPLIANCE WITH THE PERMIT CONDITIONS IS THE RESPONSIBILITY OF BOTH THE CONTRACTOR AND THE PERMITTEE.

**EROSION CONTROL NOTES
CONTRACTOR RESPONSIBILITIES**

- SEDIMENT AND EROSION CONTROLS SHALL BE INSPECTED AT LEAST ONCE A WEEK AND WITHIN 24 HOURS OF THE END OF A STORM WITH A RAINFALL AMOUNT OF 0.5 INCH OR GREATER. A LOG OF SUCH INSPECTIONS SHALL BE MAINTAINED AT THE SITE.
- THE SEDIMENT AND EROSION CONTROL PLAN SHALL BE MODIFIED BY THE CONTRACTOR AT THE DIRECTION OF THE ENGINEER AND THE TOWN'S DESIGNATED REPRESENTATIVE AS NECESSITATED BY CHANGING SITE CONDITIONS
- INSPECTION OF THE SITE FOR EROSION SHALL CONTINUE FOR A PERIOD OF THREE MONTHS AFTER COMPLETION WHEN RAINFALLS OF ONE INCH OR MORE OCCUR.
- ALL DEWATERING WASTE WATERS SHALL BE DISCHARGED IN A MANNER WHICH MINIMIZES THE DISCOLORATION OF THE RECEIVING WATERS.
- THE SITE SHOULD BE KEPT CLEAN OF LOOSE DEBRIS, LITTER, AND BUILDING MATERIALS SUCH THAT NONE OF THE ABOVE ENTER WATERS OR WETLANDS.
- A COPY OF ALL PLANS AND REVISIONS, AND THE SEDIMENT AND EROSION CONTROL PLAN SHALL BE MAINTAINED ON-SITE AT ALL TIMES DURING CONSTRUCTION.
- ALL CATCH BASIN SUMPS SHOULD BE INSPECTED AFTER CONSTRUCTION COMPLETION AND SEDIMENT REMOVED. THE SEDIMENT SHALL BE DISPOSED OF IN AN APPROVED LOCATION.

PARKING DATA		
	EXISTING	PROPOSED
STANDARD SPACES	182	130
ADA STANDARD ACCESSIBLE PARKING SPACES	3	19
ADA VAN ACCESSIBLE PARKING SPACES	0	5
TOTAL PARKING	185	154

PERFORMING ARTS CENTER ADA AND PARKING IMPROVEMENTS

**22 IRON HORSE BOULEVARD
 MAP H09, BLOCK 226, LOTS 002/003A/004
 SIMSBURY, CONNECTICUT**

SLR #11613.00025
 OCTOBER 15, 2021

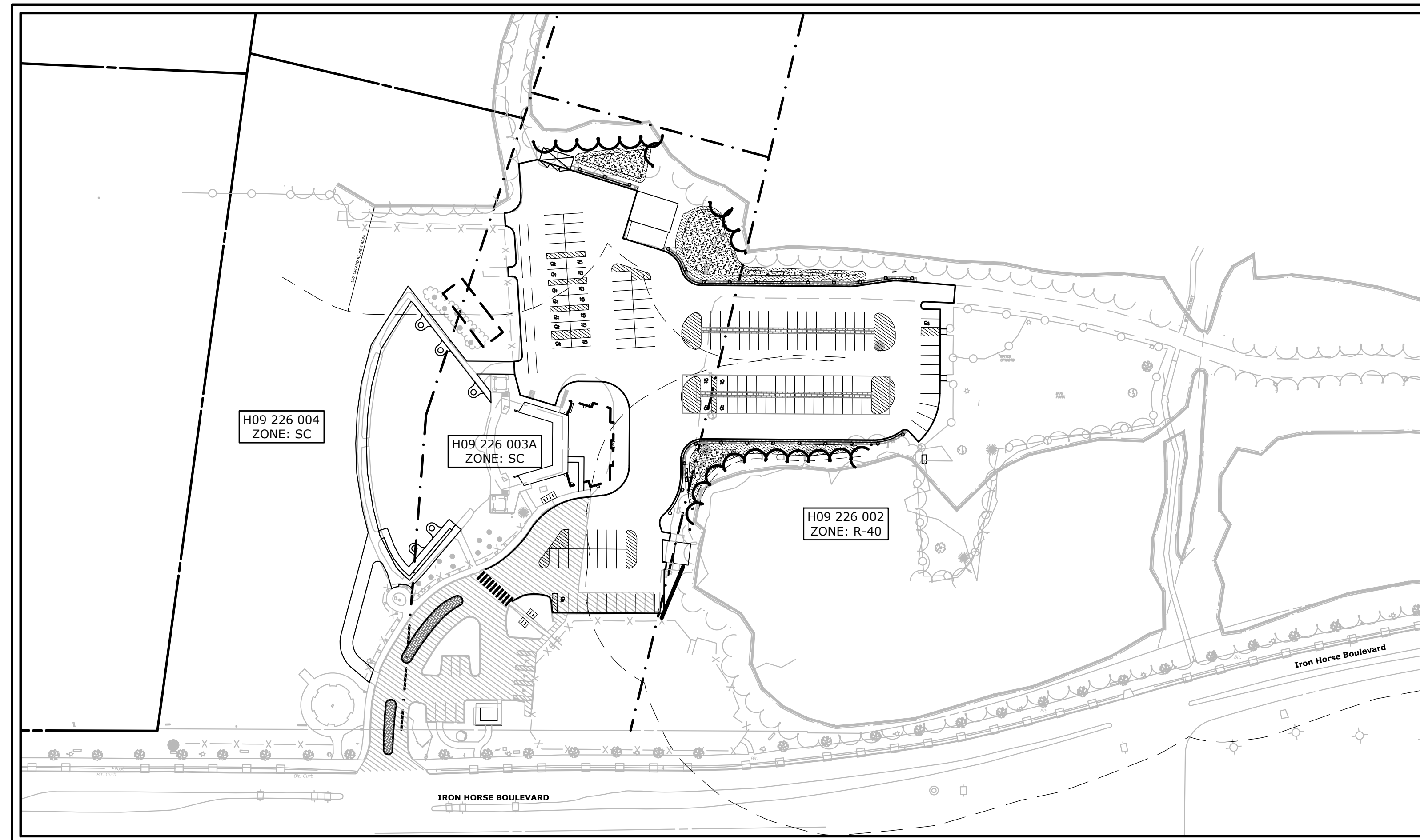

PROJECT SITE VICINITY MAP:

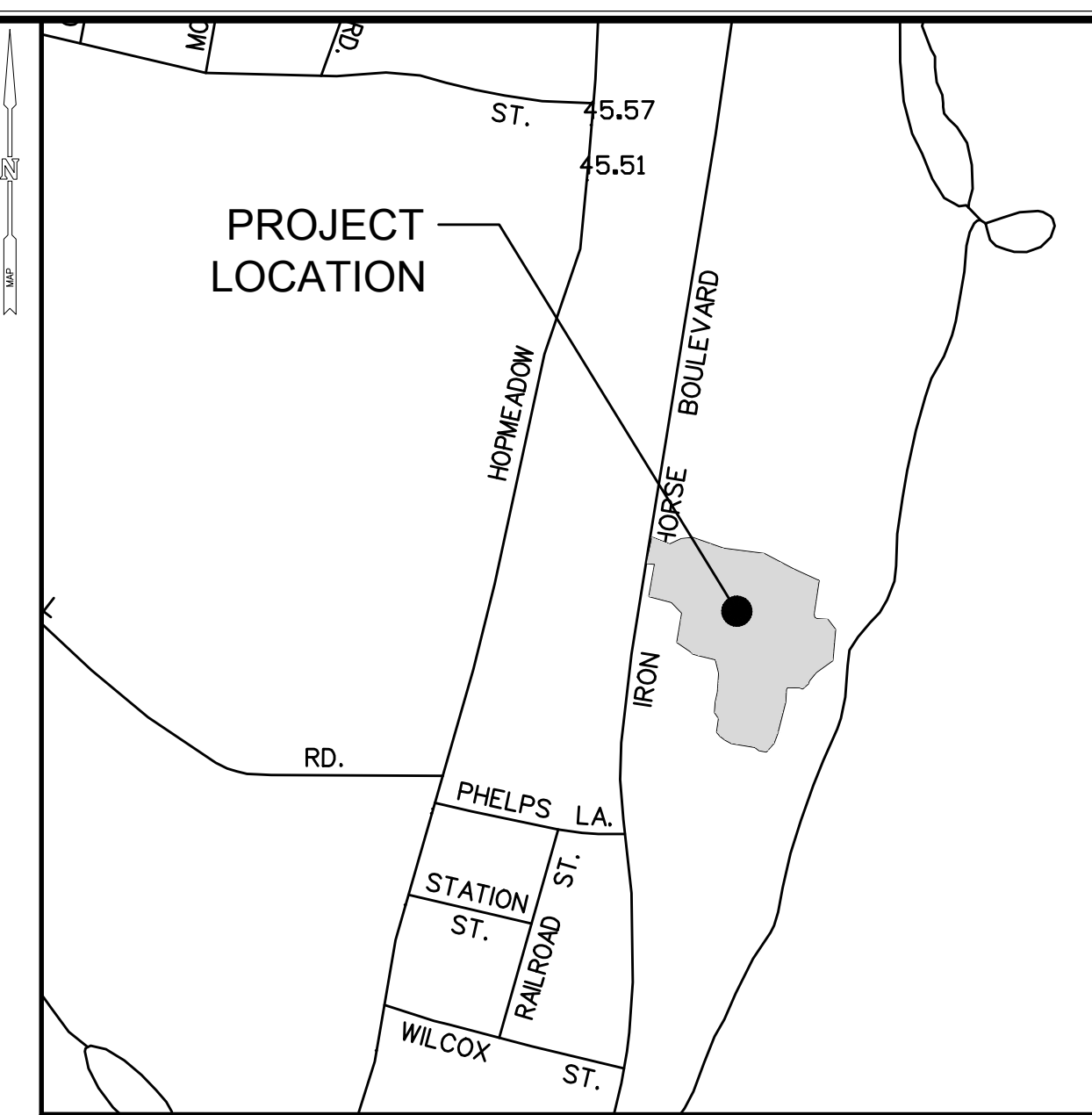
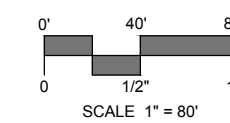

LOCATION MAP:

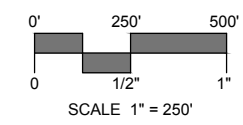

LEGEND

EXISTING		PROPOSED
---	STREET LINE	---
---	PROPERTY LINE	---
---	SETBACK LINE	---
---	MAJOR CONTOUR	---
---	MINOR CONTOUR	---
+	SPOT GRADE	+
☀	TREE/ SHRUB	☀
⊙	SITE LIGHT	⊙
⊙	WATER VALVE	⊙
⊙	GAS VALVE	⊙
⊙	CATCH BASIN	⊙
⊙	MANHOLE/YARD DRAIN	⊙
⊙	SANITARY SEWER W/MANHOLE	⊙
---	STORM DRAIN	---
---	WATER MAIN	---
---	GAS MAIN	---
---	ELECTRIC LINE	---
---	ELECTRIC, TELEPHONE, CABLE	---
⊙	UTILITY POLE	⊙
⊙	TRAFFIC SIGN	⊙
⊙	IRON PIPE	⊙
■	MONUMENT	■
---	EDGE OF PAVEMENT W/CURB	---
---	GUARD RAIL	---
---	CHAIN LINK FENCE	---
---	WATERCOURSE	---
---	WETLAND	---
---	PERMANENT ANIMEX WILDLIFE FENCING	---

PREPARED FOR:

TOWN OF SIMSBURY
 933 HOPMEADOW STREET
 SIMSBURY, CT 06070

PREPARED BY:



LIST OF DRAWINGS

NO.	NAME	TITLE
01	--	TITLE SHEET
02	EX	EXISTING CONDITIONS
03	LA	SITE PLAN - LAYOUT AND LANDSCAPING
04	GU	SITE PLAN - GRADING AND UTILITIES
05	SE-1	SEDIMENT AND EROSION CONTROL PLAN
06	SE-2	SEDIMENT AND EROSION CONTROL SPECIFICATIONS AND DETAILS
07	SD-1	SITE DETAILS
08	SD-2	SITE DETAILS



Know what's below.
 Call before you dig.
 www.cbyd.com



NOTES

- PROPERTY AND TOPOGRAPHIC INFORMATION IS COMPILED FROM A MAP TITLED "TOPOGRAPHIC PLAN, PREPARED FOR TOWN OF SIMSBURY, IRON HORSE BOULEVARD, SIMSBURY, CONNECTICUT, SCALE: 1"=30', DATE: OCTOBER 16, 2020, PREPARED BY: DENNO LAND SURVEYING & CONSULTING LLC.
- NORTH ARROW, BEARINGS AND COORDINATES ARE BASED UPON THE CONNECTICUT COORDINATE SYSTEM (NAD 1983). ELEVATIONS, CONTOURS AND BENCH MARK ARE BASED UPON (NAVD 1988)

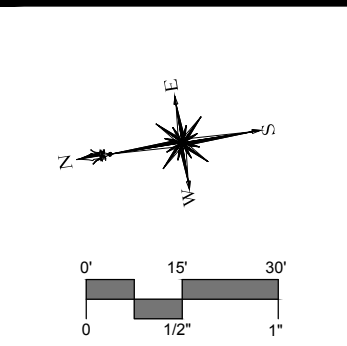

SLR
 99 REATY DRIVE
 20327177
 SIMS CONSULTING.COM

DATE	DESCRIPTION

EXISTING CONDITIONS
 SIMSBURY MEADOWS PERFORMING ARTS CENTER
 ADA AND PARKING IMPROVEMENTS
 22 IRON HORSE BOULEVARD
 SIMSBURY, CONNECTICUT

AWG	AWG	TD
DESIGNED	DRAWN	CHECKED
SCALE: 1"=30'		
DATE: OCTOBER 15, 2021		
PROJECT NO.: 11613.00025		
SHEET NO.: 02 OF 08		
EX		

DATE PLOTTED: 10/15/2021 10:52:00 AM

IRON HORSE BOULEVARD

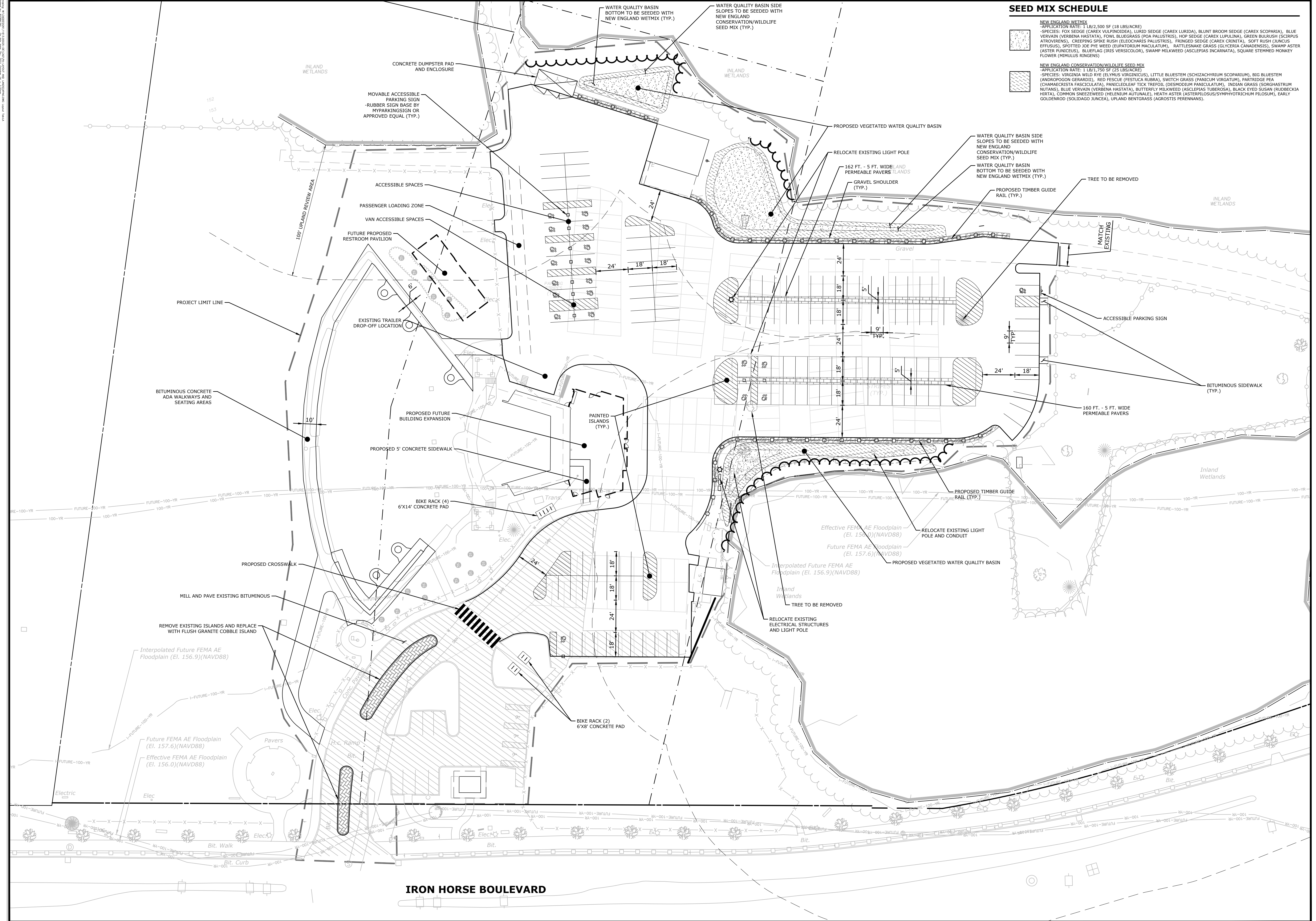

SEED MIX SCHEDULE

	NEW ENGLAND WETMIX -APPLICATION RATE: 1 LB/2,500 SF (18 LBS/ACRE) -SPECIES: FOX SEDGE (CAREX VULPINOIDEA), LURID SEDGE (CAREX LURIDA), BLUNT BROOM SEDGE (CAREX SCOPARIA), BLUE VERVAIN (VERBENA HASTATA), FOWL BLUEGRASS (POA PALUSTRIS), HOP SEDGE (CAREX LURULINA), GREEN BULRUSH (SCIRPUS ATROVIRENS), CREEPING SPIKE RUSH (ELEOCHARIS PALUSTRIS), FRINGED SEDGE (CAREX CRINITA), SOFT RUSH (JUNCUS EFUSUS), SPOTTED JOE PYE WEEED (EUPATORIUM MACULATUM), RATTLE SNAKE GRASS (GLYCERIA CANADENSIS), SWAMP ASTER (ASTER RINCEUS), BLUEFLAG (IRIS VERSICOLOR), SWAMP MILKWEED (ASCLEPIAS INCARNATA), SQUARE STEMMED MONKEY FLOWER (MIMULUS RINGENS)
	NEW ENGLAND CONSERVATION/WILDLIFE SEED MIX -APPLICATION RATE: 1 LB/1,750 SF (25 LBS/ACRE) -SPECIES: VIRGINIA WILD RYE (ELYMUS VIRGINICUS), LITTLE BLUESTEM (SCHIZACHYRIUM SCOPARIUM), BIG BLUESTEM (ANDROPOGON GERARDII), RED FESCUE (FESTUCA RUBRA), SWITCH GRASS (PANICUM VIRGATUM), PARTRIDGE PEA (CHAMAECRISTA FASCICULATA), PANICLELEAF TICK TREFOIL (DESMODIUM PANICULATUM), INDIAN GRASS (SORGHASTRUM NITENS), BLUE VERVAIN (VERBENA HASTATA), BUTTERFLY MILKWEED (ASCLEPIAS TUBEROSA), BLACK EYED SUSAN (RUDIBECKIA HIRT), COMMON SNEEZEWEED (HELENIUM AUTUNALE), HEATH ASTER (ASTERILOPUS/SYMPHYOTRICHUM PILOSUM), EARLY GOLDENROD (SOLIDAGO JUNCEA), UPLAND BENTGRASS (AGROSTIS PERENNANS)

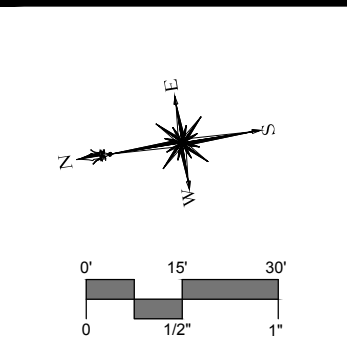

SLR
99 REALTY DRIVE
SUITE 200
SILVER SPRING, MD 20910
TEL: 410-528-1177
WWW.SLRCONSULTING.COM

DESCRIPTION	DATE	BY

SITE PLAN - LAYOUT AND LANDSCAPING
SIMSBURY MEADOWS PERFORMING ARTS CENTER
ADA AND PARKING IMPROVEMENTS
22 IRON HORSE BOULEVARD
SIMSBURY, CONNECTICUT





AWG DESIGNED	AWG DRAWN	TD CHECKED
SCALE 1"=30'		
DATE OCTOBER 15, 2021		
PROJECT NO. 11613.00025		
SHEET NO. 03 OF 08		

LA

NDDB PROTECTION STRATEGIES FOR EASTERN HOGNOSE SNAKE AND NOTHERN LEOPARD FROG

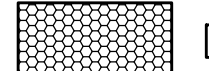
1. A QUALIFIED HERPETOLOGIST SHALL SURVEY/SWEEP THE AREAS ALONG THE LIMITS OF DISTURBANCE PRIOR TO ANY CONSTRUCTION. THIS SHALL OCCUR IMMEDIATELY PRIOR TO (WITHIN 24 HOURS) THEN IMMEDIATELY FOLLOWING THE INSTALLATION OF THE EROSION AND SEDIMENTATION CONTROL BARRIER, IF THIS WORK IS TO BE CONDUCTED FROM APRIL TO NOVEMBER WHEN SPECIES ARE NON-DORMANT.
2. A QUALIFIED HERPETOLOGIST SHALL BE HIRED TO BE ON SITE TO ENSURE THESE PROTECTION GUIDELINES REMAIN IN EFFECT AND PREVENT FROGS AND SNAKES FROM BEING RUN OVER WHEN MOVING HEAVY EQUIPMENT.
3. EXCLUSIONARY PRACTICES WILL BE REQUIRED TO PREVENT ANY FROG OR SNAKE ACCESS INTO CONSTRUCTION AREAS AND WILL CONSIST OF TEMPORARY SILT FENCE DURING CONSTRUCTION. THESE MEASURES WILL NEED TO BE INSTALLED AT THE LIMITS OF DISTURBANCE, AS INDICATED ON SITE PLANS.
4. EXCLUSIONARY FENCING MUST BE AT LEAST 20 IN TALL AND MUST BE SECURED TO AND REMAIN IN CONTACT WITH THE GROUND AND BE REGULARLY MAINTAINED (AT LEAST BI-WEEKLY AND AFTER MAJOR WEATHER EVENTS) TO SECURE ANY GAPS OR OPENINGS AT GROUND LEVEL THAT MAY LET ANIMAL PASS THROUGH. FENCING SHOULD BE INSTALLED WITH STAKES FACING IN TOWARDS THE CONSTRUCTION AREA TO REDUCE CLIMBING SURFACES FOR REPTILES. DO NOT USE PLASTIC WEB OR NETTED SILT-FENCE.
5. ALL STAGING AND STORAGE AREAS, OUTSIDE OF PREVIOUSLY PAVED LOCATIONS, REGARDLESS OF THE DURATION OF TIME THEY WILL BE UTILIZED, MUST BE REVIEWED TO REMOVE INDIVIDUALS AND EXCLUDE THEM FROM RE-ENTRY.
6. ALL CONSTRUCTION PERSONNEL WORKING WITHIN THE FROG OR SNAKE HABITAT MUST BE APPRISED OF THE SPECIES DESCRIPTION AND THE POSSIBLE PRESENCE OF A LISTED SPECIES, AND INSTRUCTED TO RELOCATE FROGS OR SNAKES FOUND INSIDE WORK AREAS OR NOTIFY THE APPROPRIATE AUTHORITIES TO RELOCATE INDIVIDUALS.
7. ANY FROGS OR SNAKES ENCOUNTERED WITHIN THE IMMEDIATE WORK AREA SHALL BE CAREFULLY MOVED TO AN ADJACENT AREA OUTSIDE OF THE EXCLUDED AREA AND FENCING SHOULD BE INSPECTED TO IDENTIFY AND REMOVE ACCESS POINT.
8. SILT FENCE TO BE REMOVED FOLLOWING COMPLETION OF CONSTRUCTION ACTIVITIES.
9. NO HEAVY MACHINERY OR VEHICLES MAY BE PARKED IN ANY LISTED SPECIES HABITAT.
10. AVOID DEGRADATION OF WETLAND HABITATS INCLUDING ANY WET MEADOWS AND SEASONAL POOLS.
11. THE CONTRACTOR OR CONSULTING HERPETOLOGIST MUST SEARCH THE WORK AREA EACH MORNING PRIOR TO ANY WORK BEING DONE.
12. WHEN FELLING TREES ADJACENT TO BROOKS AND STREAMS PLEASE CUT THEM TO FALL AWAY FROM THE WATERWAY AND DO NOT DRAG TREES ACROSS THE WATERWAY OR REMOVE STUMPS FROM BANKS.
13. AVOID AND LIMIT ANY EQUIPMENT USE WITHIN 50 FEET OF STREAMS AND BROOKS.
14. ANY CONFIRMED SIGHTINGS OF NORTHERN LEOPARD FROG OR EASTERN HOGNOSE SNAKE SHOULD BE REPORTED AND DOCUMENTED WITH THE NDDB (NDDBREQUEST@CONNECTICUT.GOV) ON THE APPROPRIATE SPECIAL ANIMAL FORM FOUND AT ([HTTP://WWW.CT.GOV/DEEP/CTVIEWS.ASP?A=270280-334668&DEPMAY_GID=1641](http://www.ct.gov/DEEP/CTVIEWS.ASP?A=270280-334668&DEPMAY_GID=1641))

EROSION CONTROL LEGEND

-  CE CONSTRUCTION ENTRANCE
-  GSF SEDIMENT FILTER FENCE
-  SW STRAW WATTLES
-  STK TEMPORARY SOIL STOCKPILE SURROUNDED WITH SEDIMENT FILTER FENCE.

SOIL EROSION AND SEDIMENT CONTROL NARRATIVE

SEDIMENT AND EROSION CONTROL MEASURES AS DEPICTED ON THESE PLANS AND DESCRIBED WITHIN THE SEDIMENT AND EROSION CONTROL NARRATIVE SHALL BE IMPLEMENTED AND MAINTAINED UNTIL PERMANENT COVER AND STABILIZATION IS ESTABLISHED. ALL SEDIMENT AND EROSION CONTROL MEASURES SHALL CONFORM TO THE "GUIDELINES FOR SOIL EROSION AND SEDIMENT CONTROL, CONNECTICUT - 2002, TOWN OF SIMSBURY STANDARDS, AND IN ALL CASES BEST MANAGEMENT PRACTICES SHALL PREVAIL.

1. PURPOSE AND DESCRIPTION OF PROJECT
 - A.) CONSTRUCTION OF A BUILDING EXPANSION AND PARKING LOT IMPROVEMENTS.
 - B.) DISTURBED AREA: ± 4.5 AC.
2. IDENTIFICATION OF EROSION AND SEDIMENT CONTROL CONCERNS
 - A.) CUTS AND FILLS ASSOCIATED WITH CONSTRUCTION.
 - B.) PROTECTION OF ON-SITE WETLANDS.
3. IDENTIFICATION OF OTHER POSSIBLE PERMITS
 - THE PERMITS REQUIRED FOR THE PROJECT ARE LOCAL INLAND WETLANDS AND PLANNING AND ZONING.
4. RESPONSIBLE PARTY
 - JEFF SHEA
 - TOWN ENGINEER, TOWN OF SIMSBURY
 - 860-658-3260

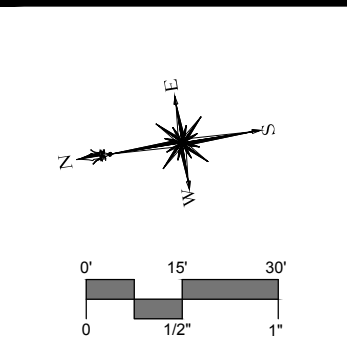
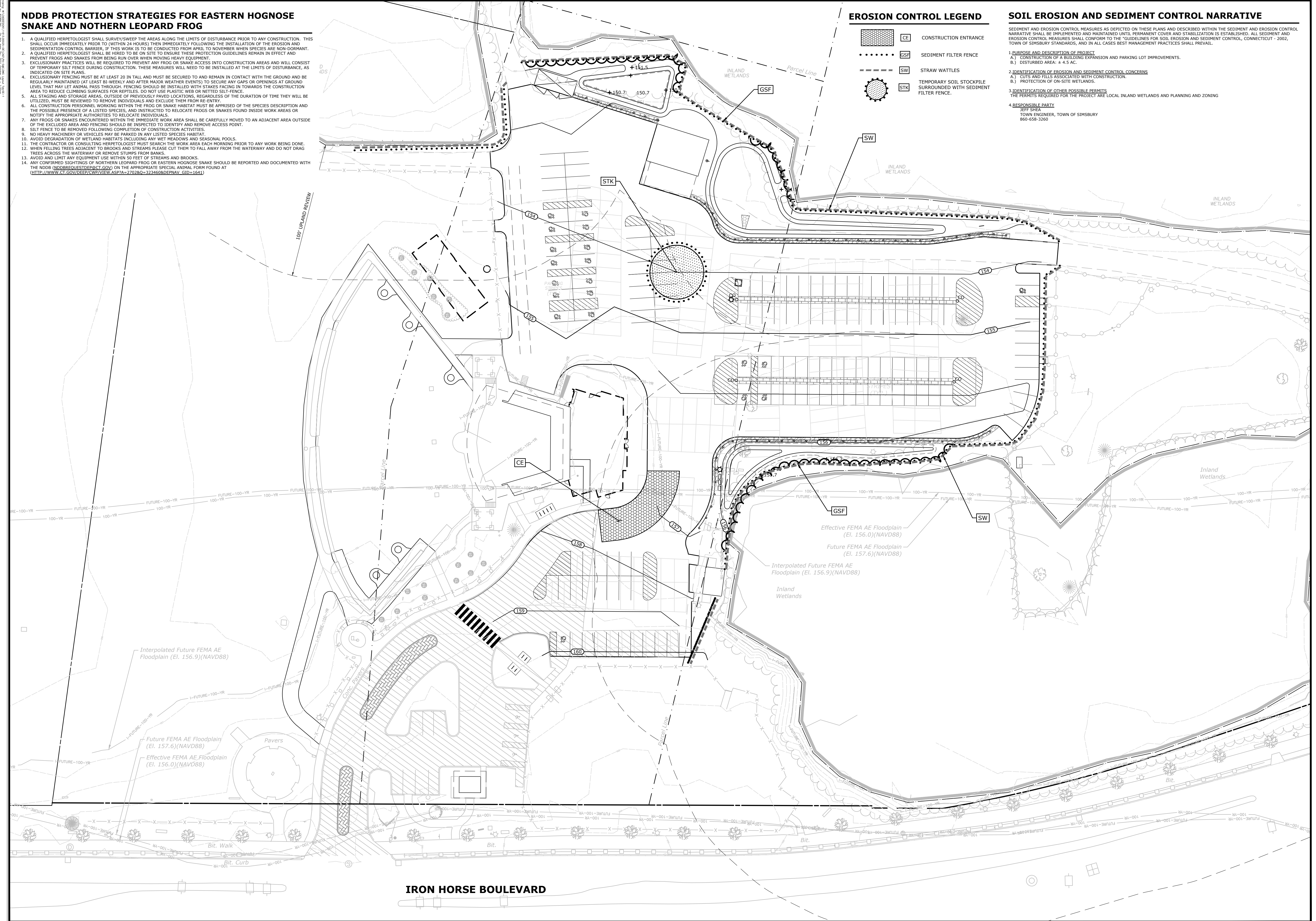

DESCRIPTION	DATE	BY

SEDIMENT AND EROSION CONTROL PLAN
SIMSBURY MEADOWS PERFORMING ARTS CENTER
ADA AND PARKING IMPROVEMENTS
 22 IRON HORSE BOULEVARD
 SIMSBURY, CONNECTICUT

AWG DESIGNED	AWG DRAWN	TD CHECKED
SCALE: 1"=30'		
DATE: OCTOBER 15, 2021		
PROJECT NO.: 11613.00025		
SHEET NO.: 05 OF 08		

SE-1

SHEET: 11-11-2021 10:00 AM 11/11/2021 10:00 AM 11/11/2021 10:00 AM
 C:\Users\slr\Documents\11-11-2021 10:00 AM 11/11/2021 10:00 AM 11/11/2021 10:00 AM

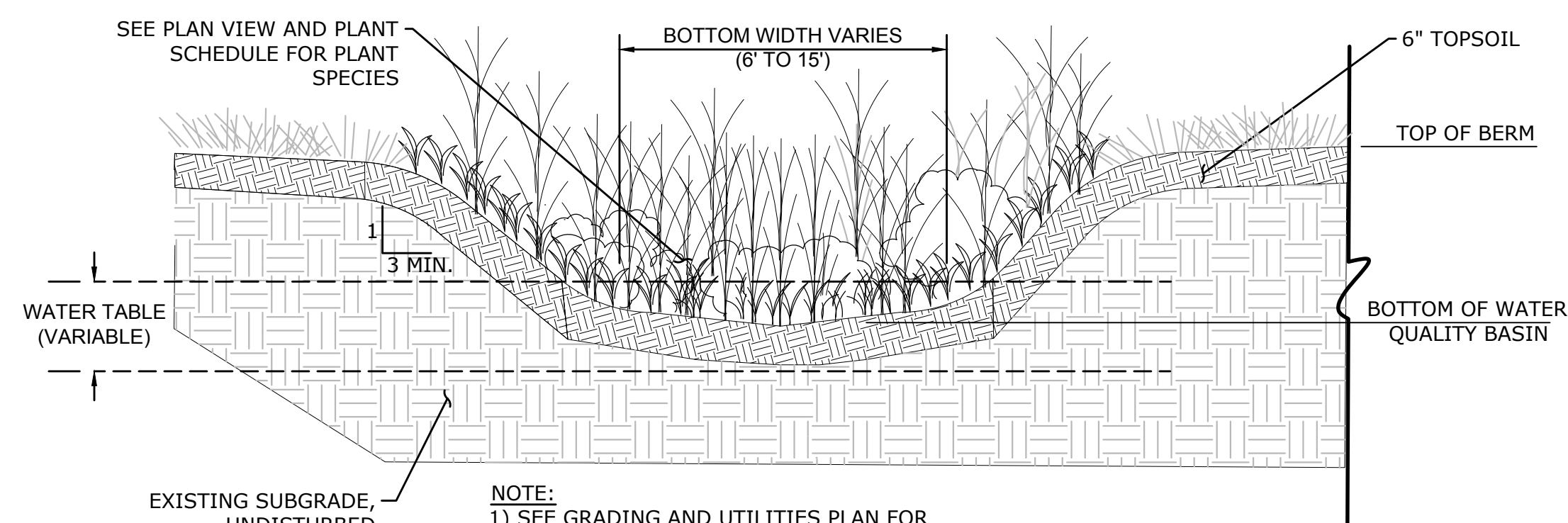

WATER QUALITY BASIN - WET BASIN
TYPICAL SECTION
 NOT TO SCALE

NOTE:
 1) SEE GRADING AND UTILITIES PLAN FOR PROPOSED ELEVATIONS

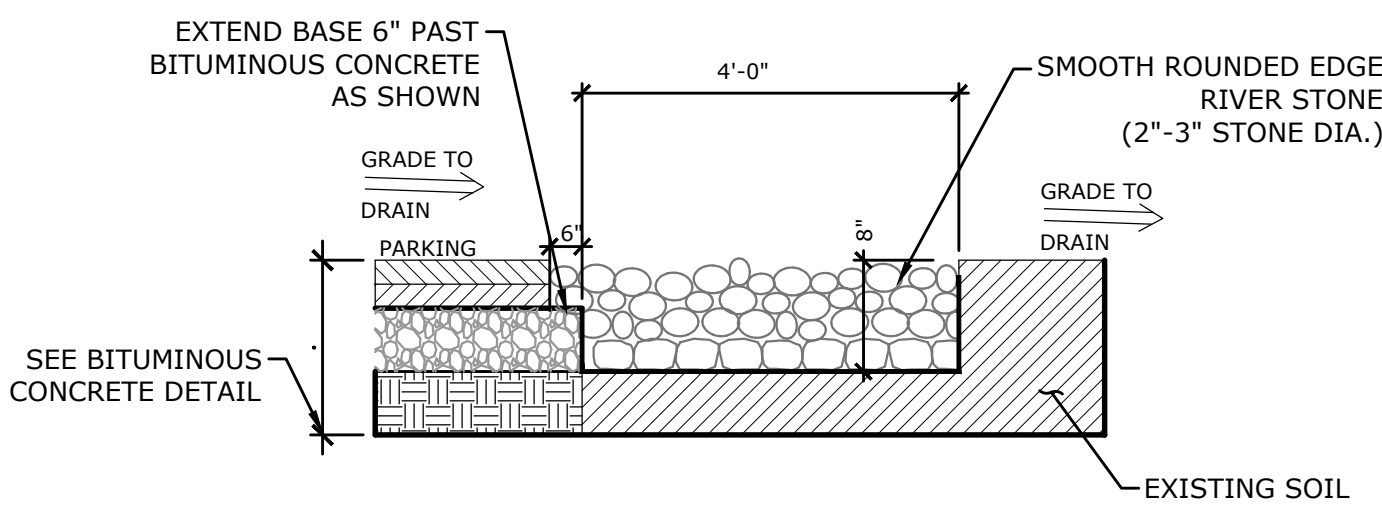

GRAVEL STRIP ALONG PARKING LOT
 NOT TO SCALE

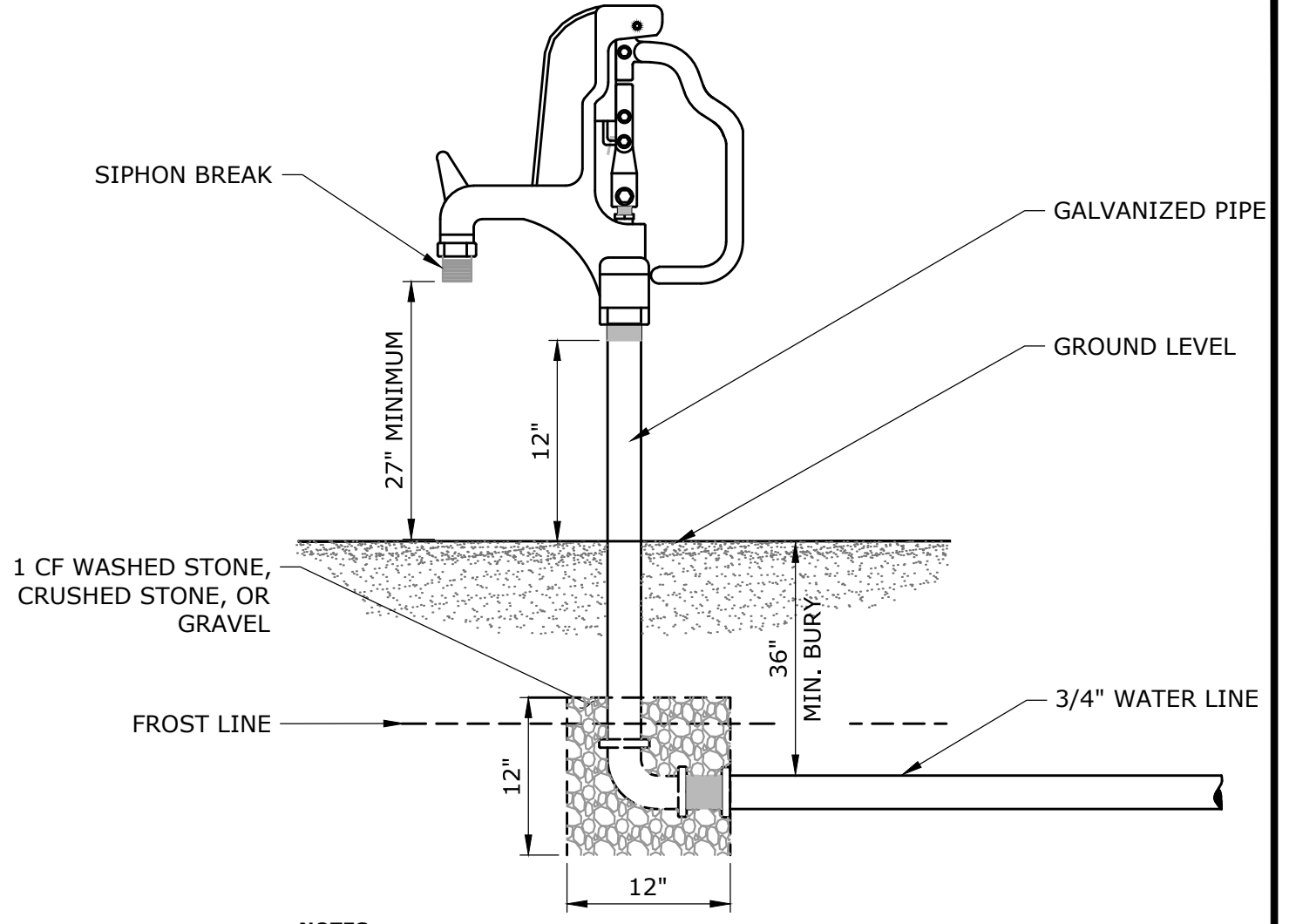

NOTES:
 1. HOSE BIB SHALL ACCOMMODATE STANDARD 3/4" GARDEN HOSE.
YARD HYDRANT (NON-FREEZE)
 NOT TO SCALE

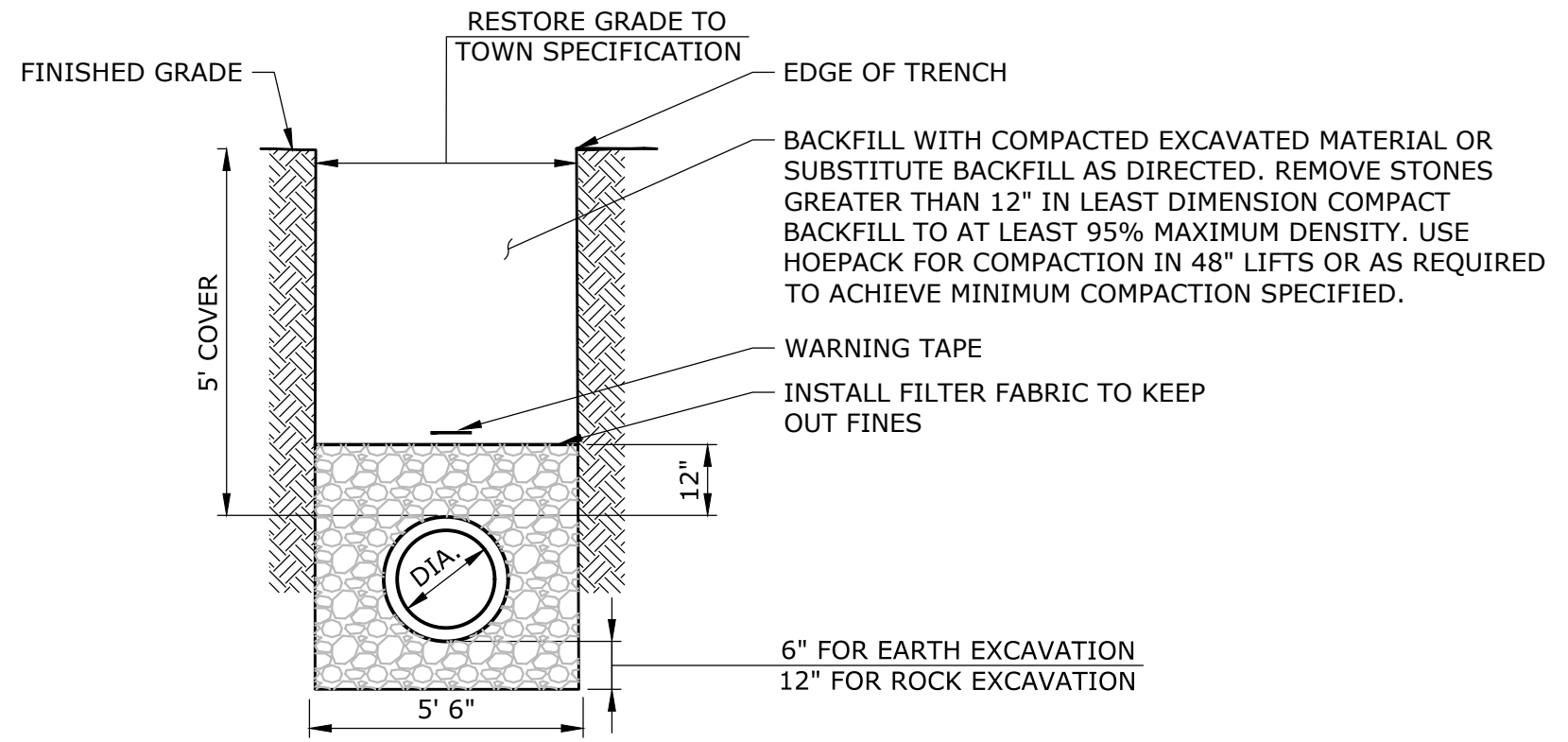

WATER MAIN TRENCH
 NOT TO SCALE

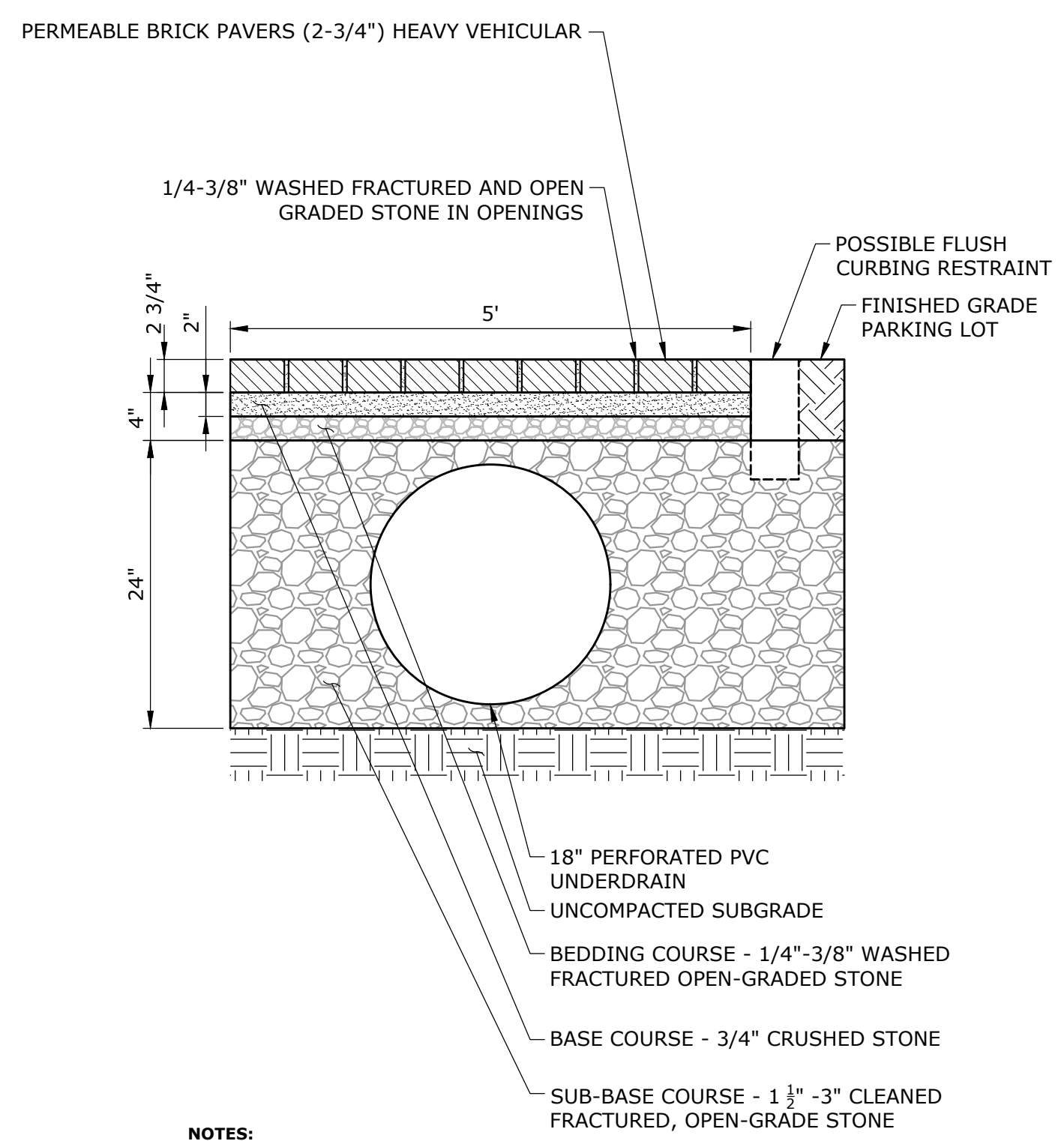

NOTES:
 1. SUBGRADE IS NOT TO BE OVER COMPACTED.
 2. ALL STONE MATERIALS ARE TO BE CLEAN AND CAREFULLY PLACED.
 3. ALLOW PAVERS TO SET BEFORE HEAVY VEHICULAR USE.
PERMEABLE BRICK PAVERS WITH UNDERDRAIN
 NOT TO SCALE

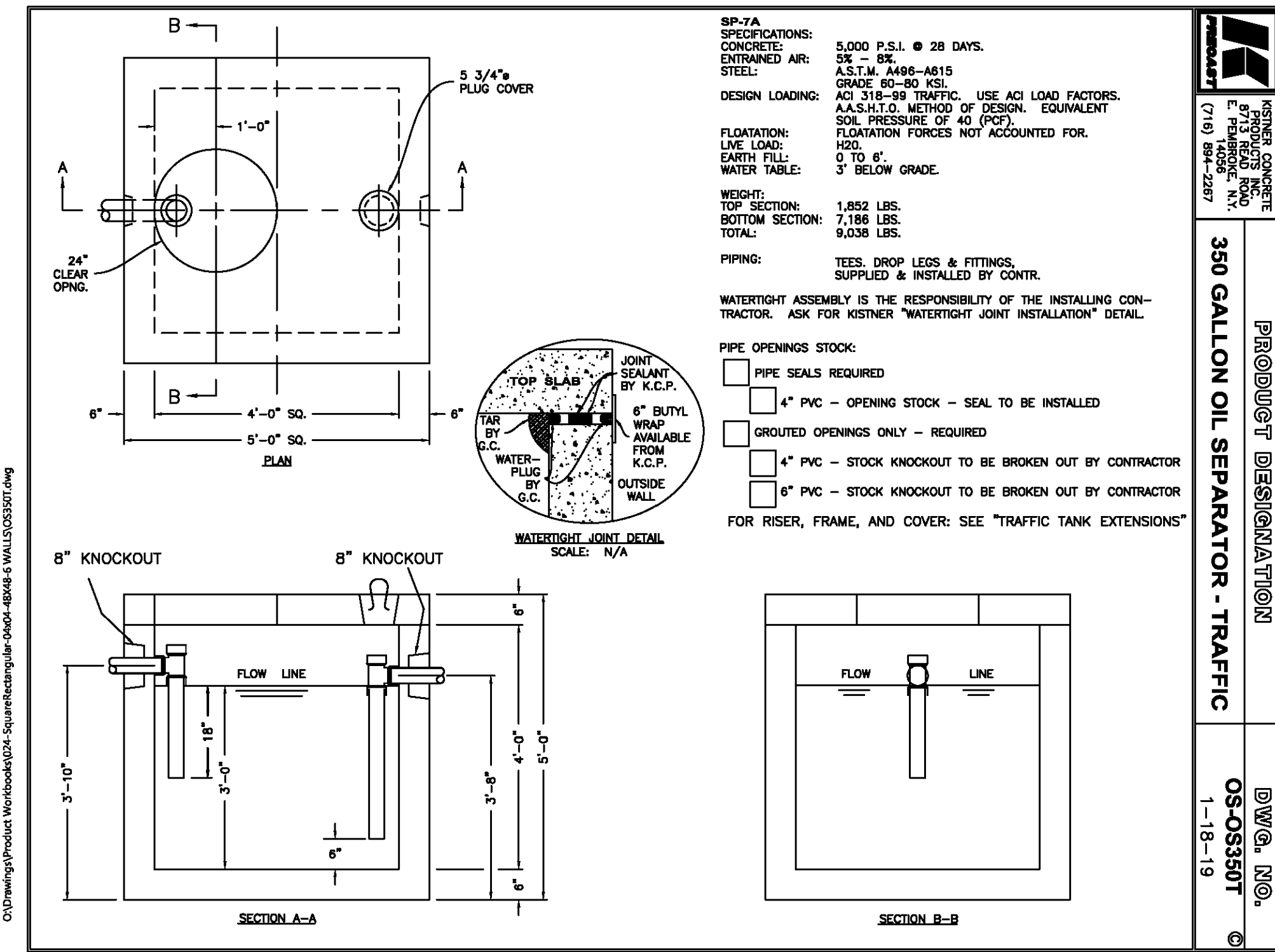

350 GALLON OIL SEPARATOR
 NOT TO SCALE

SPECIFICATIONS:
 CONCRETE: 5,000 P.S.I. @ 28 DAYS.
 ENTRAINED AIR: 5% - 6%
 STEEL: A.S.T.M. A496-A615
 GRADE 60-80 KSI
 DESIGN LOADING: ACI 318-89 TRAFFIC. USE ACI LOAD FACTORS.
 A.A.S.H.T.O. METHOD OF DESIGN. EQUIVALENT
 SOIL PRESSURE OF 40 (PCF).
 FLOATION FORCES NOT ACCOUNTED FOR.
 FLDATION: 120
 EARTH FILL: 0 TO 6"
 WATER TABLE: 3' BELOW GRADE.
 WEIGHT:
 TOP SECTION: 1,852 LBS.
 BOTTOM SECTION: 7,186 LBS.
 TOTAL: 9,038 LBS.
 PIPING: TEES, DROP LEGS & FITTINGS,
 SUPPLIED & INSTALLED BY CONTR.
 WATER TIGHT ASSEMBLY IS THE RESPONSIBILITY OF THE INSTALLING CONTRACTOR. ASK FOR KISTNER "WATER TIGHT JOINT INSTALLATION" DETAIL.
 PIPE OPENINGS STOCK:
 PIPE SEALS REQUIRED
 4" PVC - OPENING STOCK - SEAL TO BE INSTALLED
 GROUTED OPENINGS ONLY - REQUIRED
 4" PVC - STOCK KNOCKOUT TO BE BROKEN OUT BY CONTRACTOR
 8" PVC - STOCK KNOCKOUT TO BE BROKEN OUT BY CONTRACTOR
 FOR RISER, FRAME, AND COVER: SEE "TRAFFIC TANK EXTENSIONS"
 PRODUCT DESIGNATION: 350 GALLON OIL SEPARATOR - TRAFFIC
 DIV. NO.: OS-05350T
 1-18-19

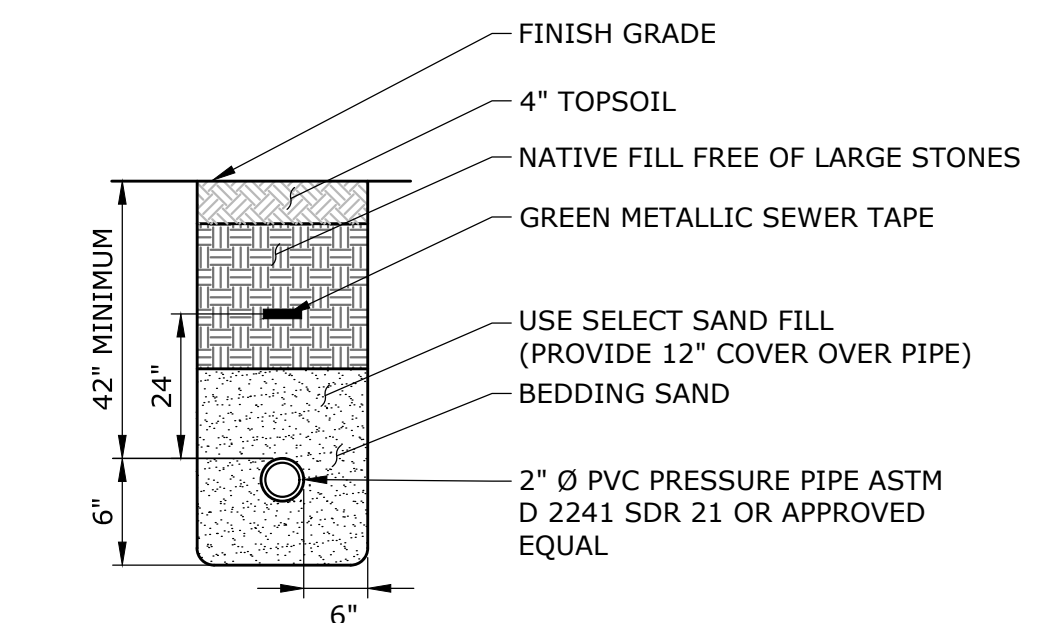

FORCE MAIN TRENCH
 NOT TO SCALE

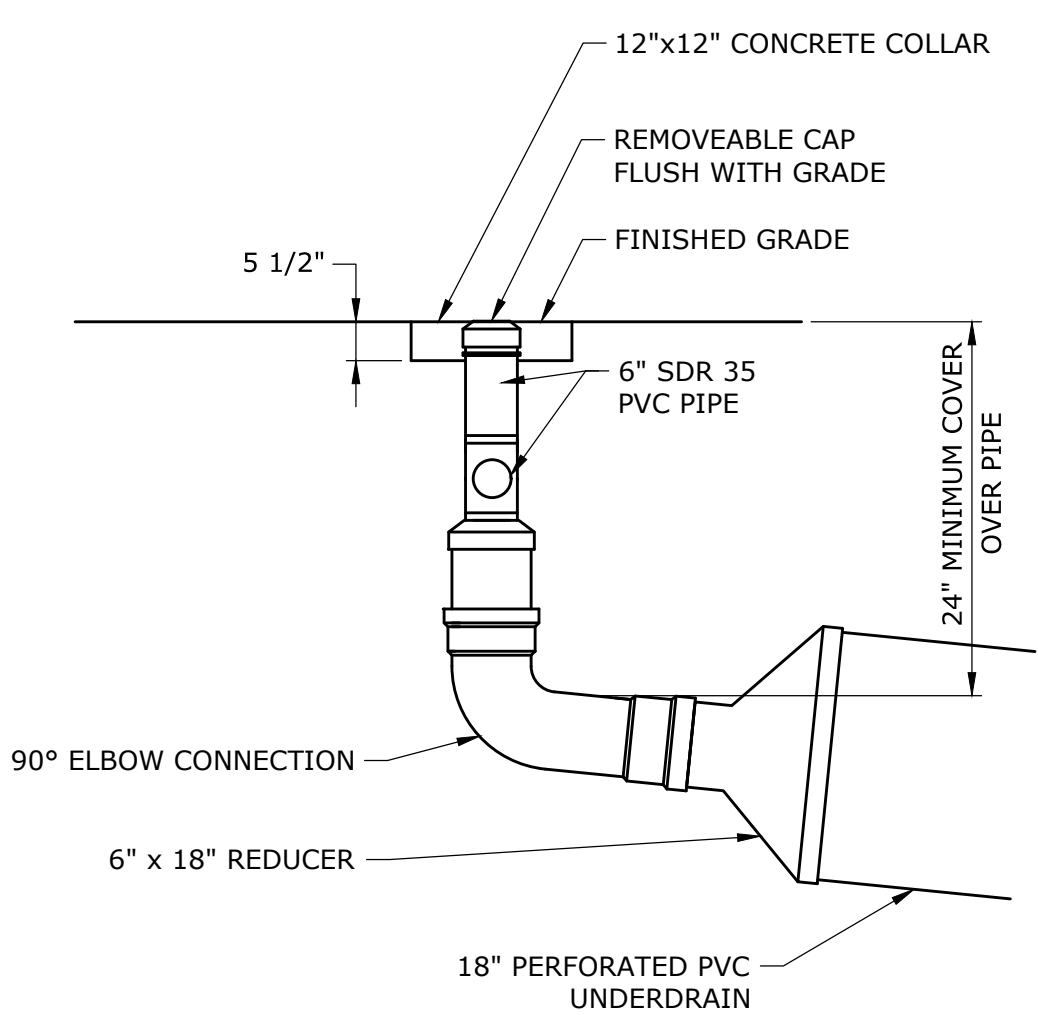

NOTES:
 1. SEE SITE PLAN FOR CLEAN-OUT LOCATIONS.
6" UNDERDRAIN CLEANOUT
 NOT TO SCALE

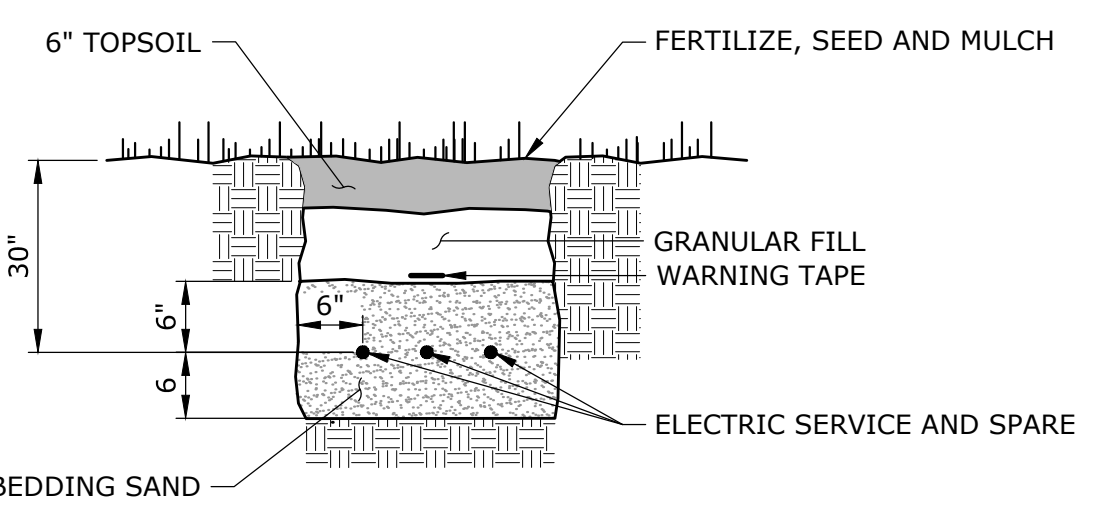

ELECTRICAL UTILITY TRENCH
 NOT TO SCALE



DESCRIPTION	DATE	BY

SITE DETAILS
 SIMSBURY MEADOWS PERFORMING ARTS CENTER
 ADA AND PARKING IMPROVEMENTS
 22 IRON HORSE BOULEVARD
 SIMSBURY, CONNECTICUT

AWG DESIGNED	AWG DRAWN	AWG CHECKED
SCALE: AS NOTED		
DATE: OCTOBER 15, 2021		
PROJECT NO.: 11613.00025		
SHEET NO.: 08 OF 08		

SD-2