



**Tecton**  
ARCHITECTS

# LATIMER LANE SCHOOL

*STATE PROJECT NO. 128-0111 RNV*

DESIGN REVIEW BOARD MEETING

FEBRUARY 7, 2022

# LATIMER LANE ELEMENTARY SCHOOL

Town of Simsbury, Connecticut

State Project No. 128-0111 RNV



ARCHITECTURE, INTERIOR DESIGN, FF&E

### PROJECT LEADERSHIP

**Jeff Wyszynski, AIA**  
Principal in Charge

**Justin Hopkins, RA**  
Project Manager

### DESIGN

**Ernest Nepomuceno, LEED AP**  
Senior Designer

**Kathryn Mease, NCIDQ, LEED AP BD+C, EDAC**  
Senior Interior Designer

**Nicole Tetreault, NCIDQ**  
Registered Interior Designer

### TECHNICAL RESOURCES

**Alison Fredericks, Associate AIA**  
Job Captain

**César Rodríguez**  
Production Leader

### SPECIALTIES

**Eddie Widofsky, AIA LEED AP BD+C**  
Educational Programming & Planning Specialist

**Antonia Claverella, EDAC, WELL AP, LEED AP BD+C, FitWell**  
Architectural Designer, Sustainability & Wellness

*Additional in-house resources in School Safety, Code and Design Visualization*

### CONSULTANT TEAM

**CONSULTING ENGINEERING SERVICES**  
MECHANICAL, ELECTRICAL, PLUMBING  
ENGINEERING, FIRE PROTECTION, TECHNOLOGY

**SLR INTERNATIONAL  
(FORMERLY MILONE & MACBROOM)**  
CIVIL ENGINEERING, WETLANDS, GEOTECHNICAL,  
TRAFFIC, SURVEY

**RICHTER & CEGAN**  
LANDSCAPE ARCHITECTURE

**PAN AMERICAN CONSULTING  
SERVICES**  
COST ESTIMATING

**MICHAEL HORTON ASSOCIATES**  
STRUCTURAL ENGINEERING

**CRABTREE MCGRATH**  
KITCHEN DESIGN



**Arcadis International**  
Owner's Project Manager



**O&G Industries**  
Construction Manager



**Sustainable Engineering Solutions**  
Building Commissioning

# Site Plan Development

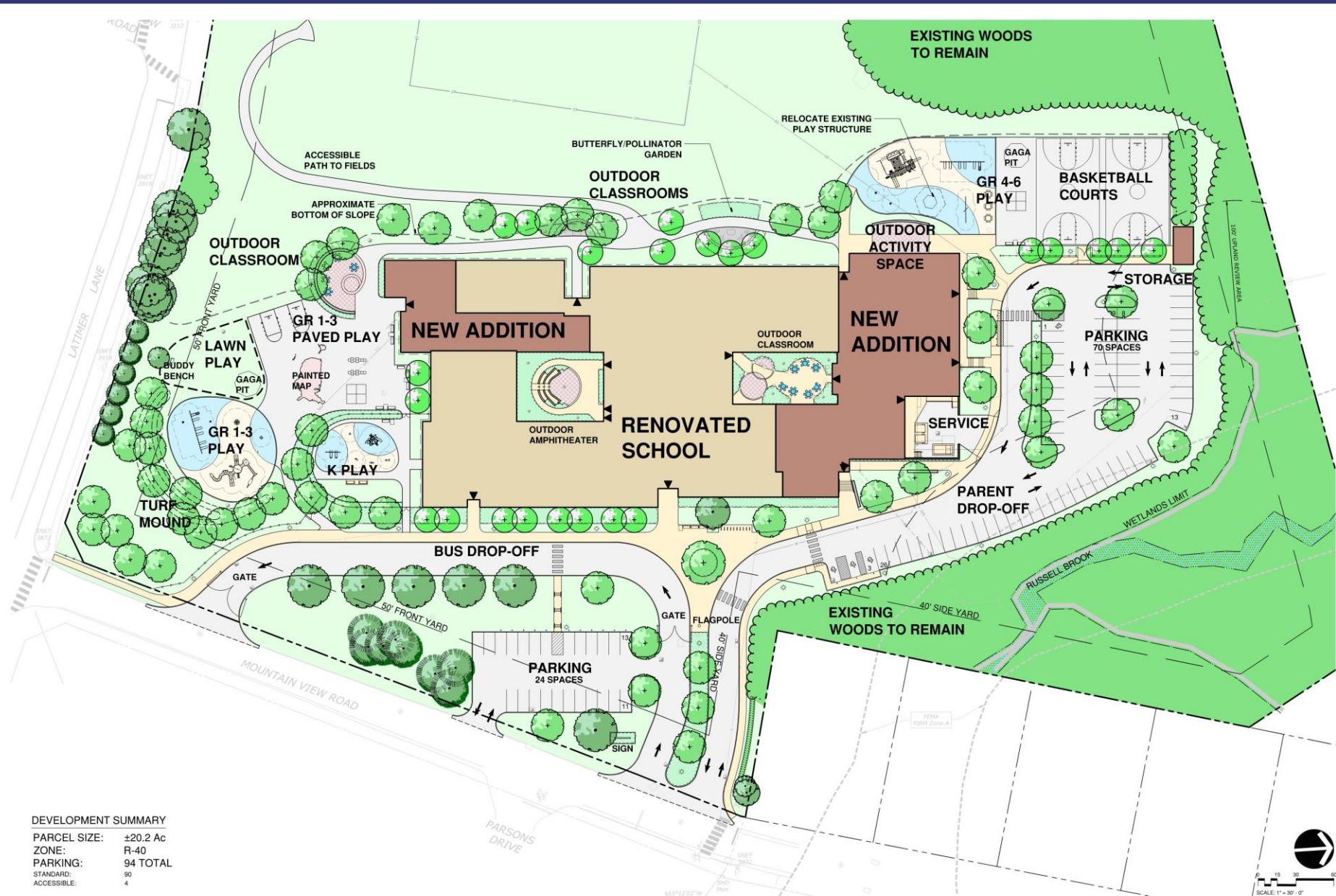

**DEVELOPMENT SUMMARY**  
 PARCEL SIZE: ±20.2 Ac  
 ZONE: R-40  
 PARKING: 94 TOTAL  
 STANDARD: 90  
 ACCESSIBLE: 4



# View from Mountain View Road



Tecton  
ARCHITECTS





# Outdoor Learning Spaces

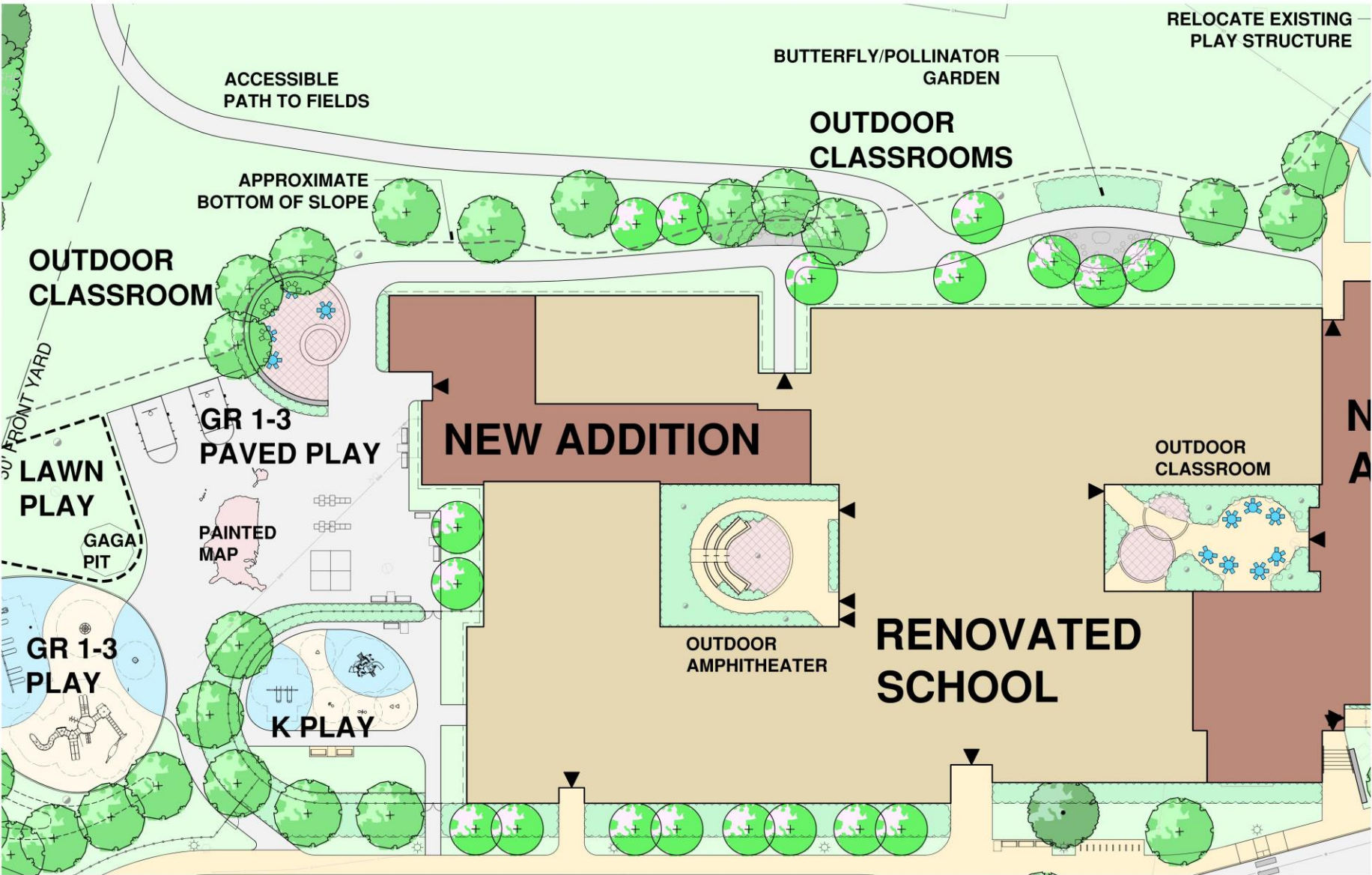



# Outdoor Learning Spaces



Tecton  
ARCHITECTS





# Outdoor Play

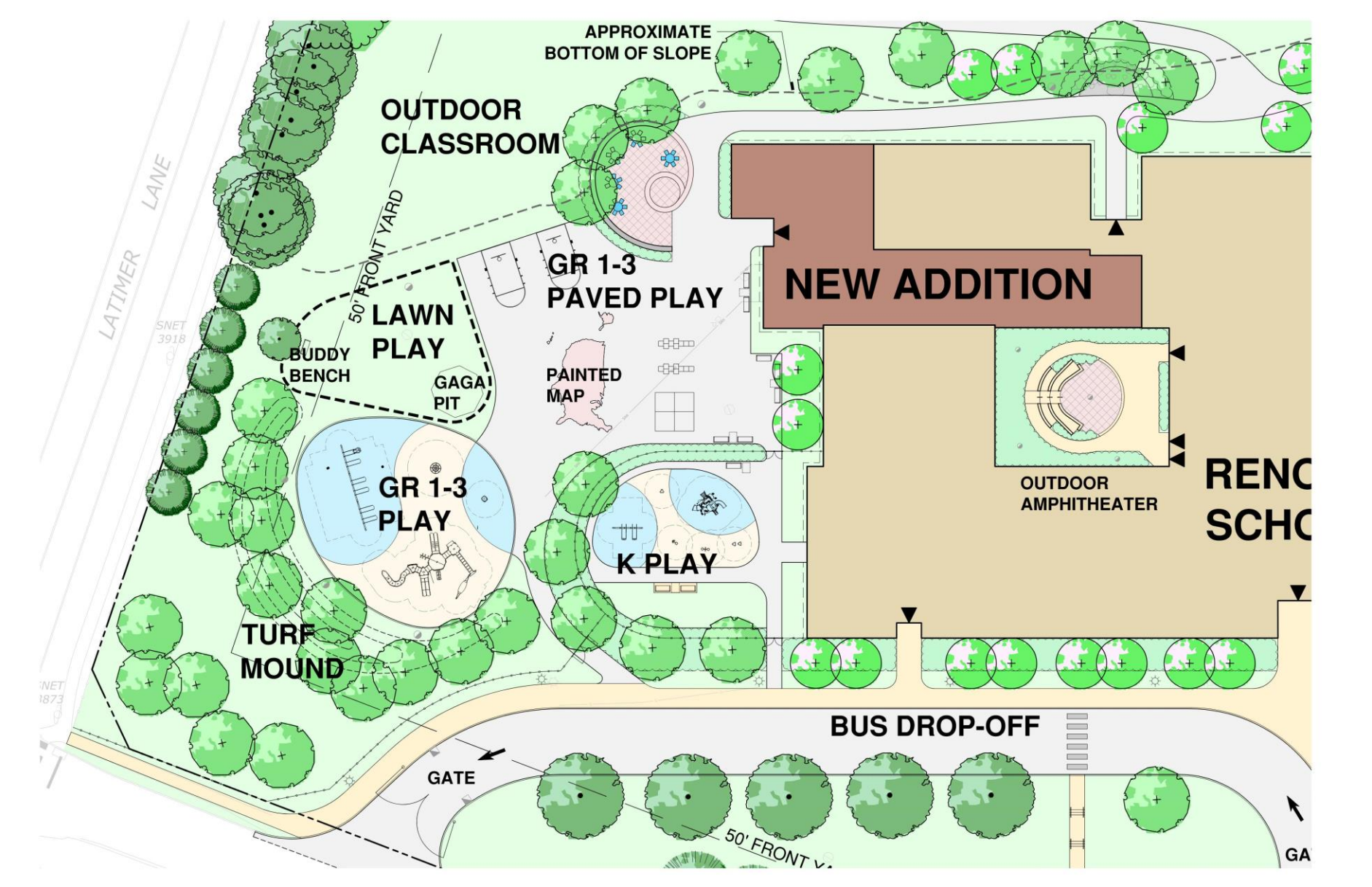



# Outdoor Play



Tecton  
ARCHITECTS





# View from Latimer Lane



Tecton  
ARCHITECTS



Google Earth

© 2022 Google

# Planting Development

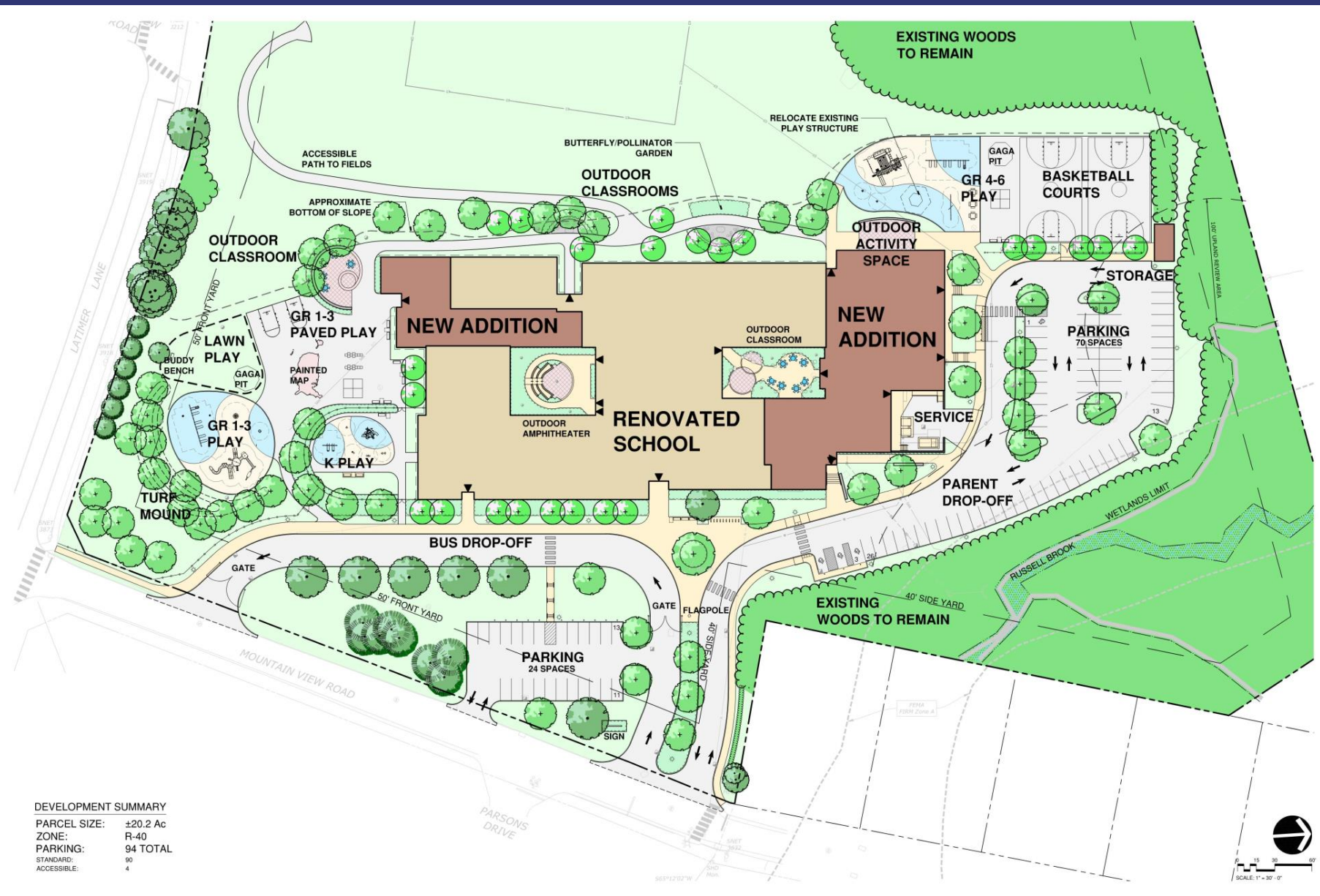

DEVELOPMENT SUMMARY

PARCEL SIZE:	±20.2 Ac
ZONE:	R-40
PARKING:	94 TOTAL
STANDARD:	90
ACCESSIBLE:	4



# Planting Development



PLANT SCHEDULE							
CATEGORY	SYM	BOTANICAL NAME	COMMON NAME	QUANTITY	SIZE	COMMENTS	
TREES	AG	AMELANCHIER GRANDIFLORA 'AUTUMN BRILLIANCE'	AUTUMN BRILLIANCE SERVICEBERRY	5	3-3 1/2" CAL	B&B	
	AR	ACER RUBRUM 'RED SUNSET'	RED MAPLE	10	3-3 1/2" CAL	B&B	
	AS	ACER SACHARINUM 'LEGACY'	SUGAR MAPLE	8	3-3 1/2" CAL	B&B	
	BN	BETULA NIGRA 'DURA HEAT'	DURA HEAT RIVER BIRCH	3	3-3 1/2" CAL	B&B	
	BND	BETULA NIGRA 'DURA HEAT'	DURA HEAT RIVER BIRCH	12	14-16' HT. MULTI-STEM	B&B, MIN. 3-5 TRUNKS, FULL SPECIMEN	
	CFP	CORNUS FLORIDA 'CHEROKEE PRINCESS'	CHEROKEE PRINCESS DOGWOOD	5	3-3 1/2" CAL	B&B	
	GT	GLEDITSIA TRIACANTHOS VAR. INERMIS 'SHADEMASTER'	SHADEMASTER HONEYLOCUST	5	3-3 1/2" CAL	B&B	
	PI	PRUNUS X INCAM 'OKAME'	OKAME FLOWERING CHERRY	8	3-3 1/2" CAL	B&B, HEAVY	
	PS	PRUNUS SARGENTII	SARGENT FLOWERING CHERRY	5	3-3 1/2" CAL	B&B, HEAVY	
	QP	QUERCUS PALUSTRIS	PIN OAK	6	3-3 1/2" CAL	B&B, UNIFORM, HIGH BRANCHED TO 6'	
	OR	QUERCUS RUBRA	RED OAK	1	3-3 1/2" CAL	B&B	
	TC	TILIA CORDATA 'GREENSPIRE'	LITTLE LEAF LINDEN	2	3-3 1/2" CAL	B&B	
	UP	ULMUS PAVIFOLIA 'ALLEE'	ALLEE CHINESE ELM	3	3-3 1/2" CAL	B&B, UNIFORM, HIGH BRANCHED TO 6'	
	ZS	ZELKOVA SERRATA 'GREEN VASE'	GREEN VASE JAPANESE ZELKOVA	5	3-3 1/2" CAL	B&B	
	TREES (EVERGREEN)	PP	PICEA PUNGENS	BLUE SPRUCE	6	7-8' HT.	B&B
		AZ	AZALEA VARIETIES	AZALEA	24-30"		B&B OR CONTAINER
	SHRUBS (DECIDUOUS) QTY: 402	CA	CLETHRA ALNIFOLIA VARIETIES	SUMMER SWEET	24-30"		CONTAINER
		FG	FOTHERGILLA GARDENII 'BLUE MIST'	DWARF FOTHERGILLA	24-30"		CONTAINER
HQP		HYDRANGEA QUERCIFOLIA SPECIES	HYDRANGEA	24-30"		B&B OR CONTAINER	
IV		ITEA VIRGINICA VARIETIES	VIRGINIA SWEETSPICE	24-30"		B&B OR CONTAINER	
MP		MYRTICA PENNSYLVANICA	NORTHERN BAYBERRY	24-30"		B&B OR CONTAINER	
RA		RHUS AROMATICA 'GRO LOW'	GRO LOW FRAGRANT SUMAC	24-30"		CONTAINER	
VA		VACCINIUM ANGUSTIFOLIUM	LOWBUSH BLUEBERRY	18-24"		CONTAINER	
ICS		ILEX CRENATA VARIETIES	JAPANESE HOLLY	3-3 1/2" HT.		B&B, FULL	
IGC		ILEX GLABRA VARIETIES	INKBERRY HOLLY	24-30"		B&B OR CONTAINER	
JH		JUNIPERUS HORIZONTALIS 'BAR HARBOR'	BAR HARBOR CREEPING JUNIPER	15-18" SPD.		CONTAINER	
SHRUBS (EVERGREEN) QTY: 580	KL	KALMIA LATIFOLIA VARIETIES	MOUNTAIN LAUREL	24-30"		B&B OR CONTAINER	
	MD	MICROBIOTA DECUSSATA	RUSSIAN ARBORVITAE	18-24" SPD.		B&B OR CONTAINER	
	RY	RHODODENDRON VARIETIES	RHODODENDRON	24-30"		B&B OR CONTAINER	
	an	ASTER VARIETIES	ASTER	1 GAL.		CONTAINER @ 24" O.C.	
	at	ASCLEPIAS TUBEROSA	BUTTERFLY MILKWEED	1 GAL.		CONTAINER @ 24" O.C.	
	gsk	CALAMAGROSTIS X ACUTIFOLIA 'KARL FOERSTER'	KARL FOERSTER FEATHER REED GRASS	1 GAL.		CONTAINER @ 18" O.C.	
	efc	ELIOMYRUS FORTUNEI COLORATUS	WINTERCREEPER	#1 CONT.		CONTAINER @ 15" O.C.	
	fg	FESTUCA GLAUCA 'ELIJAH BLUE'	BLUE FESCUE	1 GAL.		CONTAINER @ 15" O.C.	
	ha	HEUCHERA VARIETIES	CORAL BELLS	1 GAL.		CONTAINER @ 24" O.C.	
	he	HEMEROCALLIS VARIETIES	DAYLILY	1 GAL.		CONTAINER @ 24" O.C.	
PERENNIALS AND GROUNDCOVERS QTY: 1622	hse	HOSTA VARIETIES	HOSTA	1 GAL.		CONTAINER @ 24" O.C.	
	ln	LIRIOPE MUSCARI 'BIG BLUE'	LILY TURF	1 GAL.		CONTAINER @ 12" O.C.	
	oc	OSMUNDA CINNAMOMEA	CINNAMON FERN	1 GAL.		CONTAINER @ 36" O.C.	
	pa	POLYSTICHUM ACROSTICHOIDES	CHRISTMAS FERN	1 GAL.		CONTAINER @ 24" O.C.	
	path	PENNISETUM ALOPECUROIDES 'HAMMELN'	DWARF FOUNTAIN GRASS	1 GAL.		CONTAINER @ 24" O.C.	
	pt	PACHYSANDRA TERMINALIS	SPURGE	2 YR. ROOTED CUTTING		6" O.C.	
	pvr	PANICUM VIRGATUM 'RUBY RIBBONS'	SWITCHGRASS	1 GAL.		CONTAINER @ 24" O.C.	
	rf	RUDEBECKIA VARIETIES	BLACK-EYED SUSAN	1 GAL.		CONTAINER @ 24" O.C.	
	ss	SCHIZACHYRIUM SCOPARIUM 'THE BLUES'	LITTLE BLUESTEM	1 GAL.		CONTAINER @ 24" O.C.	
	vm	VINCA MINOR	PERIWINKLE	2 YR. ROOTED CUTTING		6" O.C.	

BUTTERFLY/POLLINATOR GARDEN PLANT SCHEDULE						
CATEGORY	SYM	BOTANICAL NAME	COMMON NAME	QUANTITY	SIZE	COMMENTS
SHRUBS (DECIDUOUS) QTY: 51	BD	Buddleia VARIETIES	BUTTERFLY BUSH	24-30"		CONTAINER
	CA	CLETHRA ALNIFOLIA VARIETIES	SUMMER SWEET	24-30"		CONTAINER
	DL	DIERVILLA LONICERA	DWARF BUSH HONEYSUCKLE	24-30"		CONTAINER
	FG	FOTHERGILLA GARDENII 'BLUE MIST'	DWARF FOTHERGILLA	24-30"		CONTAINER
	IV	ITEA VIRGINICA 'HENRY'S GARNET'	HENRY'S GARNET VIRGINIA SWEETSPICE	24-30"		B&B OR CONTAINER
	IVL	ITEA VIRGINICA 'LITTLE HENRY'	LITTLE HENRY VIRGINIA SWEETSPICE	18-24"		B&B OR CONTAINER
PERENNIALS AND GROUNDCOVERS QTY: 87	VA	VACCINIUM ANGUSTIFOLIUM	LOWBUSH BLUEBERRY	18-24"		CONTAINER
	an	ASTER VARIETIES	ASTER	1 GAL.		CONTAINER @ 24" O.C.
	at	ASCLEPIAS SPECIES	MILKWEED	1 GAL.		CONTAINER @ 24" O.C.
	ec	ECHINACEA VARIETIES	CONEFLOWER	1 GAL.		CONTAINER @ 24" O.C.
	eu	EUPATORIUM VARIETIES	JOE PYE WEED	1 GAL.		CONTAINER @ 24" O.C.
	lt	LIATRIS VARIETIES	BLAZING STAR	1 GAL.		CONTAINER @ 18" O.C.
	mn	MONARDA VARIETIES	BEEBALM	1 GAL.		CONTAINER @ 24" O.C.
	rf	RUDEBECKIA VARIETIES	BLACK-EYED SUSAN	1 GAL.		CONTAINER @ 24" O.C.
	za	ZIZIA APTERA	HEART-LEAVED ALEXANDERS	1 GAL.		CONTAINER @ 15" O.C.

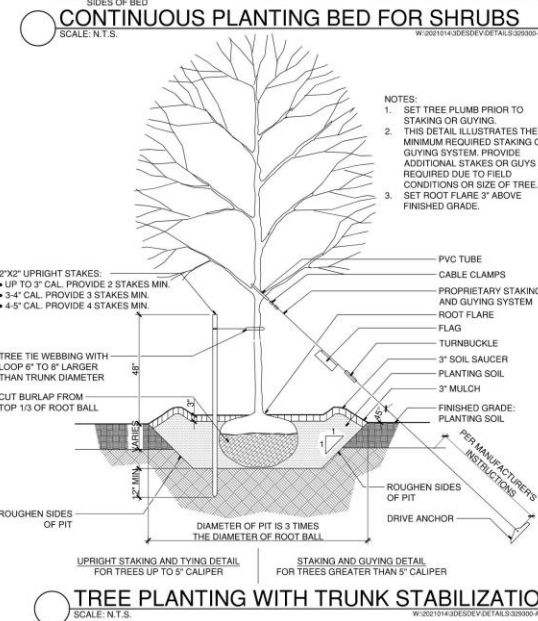
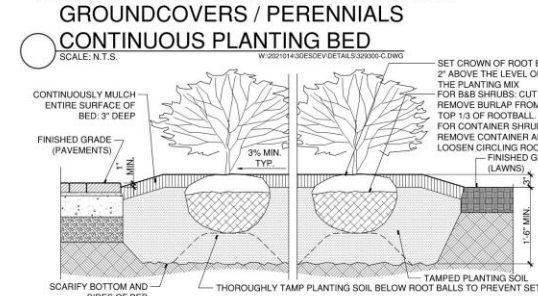
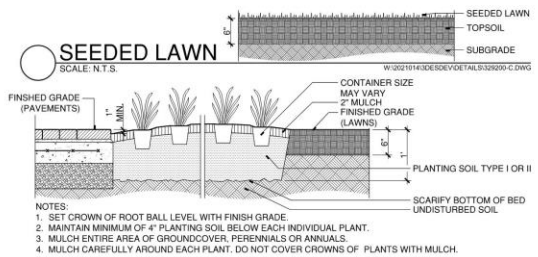

# Site Plan Development

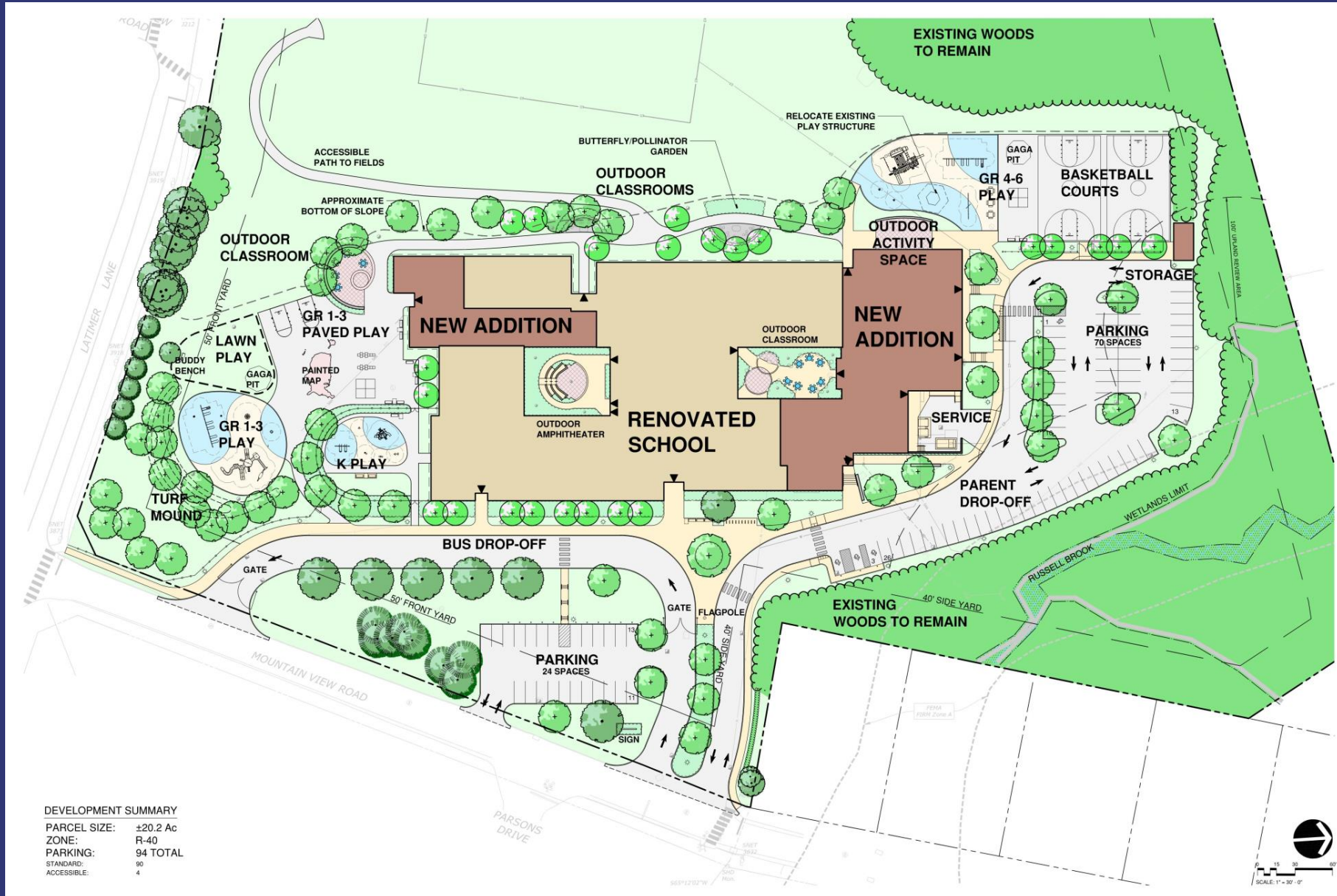

**DEVELOPMENT SUMMARY**

PARCEL SIZE:	±20.2 Ac
ZONE:	R-40
PARKING:	94 TOTAL
STANDARD:	90
ACCESSIBLE:	4



# Floor Plan Development





# View from Mountain View Road



Tecton  
ARCHITECTS





# View from Latimer Lane



Tecton  
ARCHITECTS





# View from the North



Tecton  
ARCHITECTS





# Façade Development

## BRICK VENEER

- Ironspot Brick - black
  - Gymnasium addition – north, west
- Beige Brick
  - North addition – east
- Brick to match existing
  - Southwest classroom addition

## FORMED METAL WALL PANEL

- Gymnasium - east, south, west
  - Light grey or charcoal grey

## GLAZING

- SSG Curtain Wall System
  - Dark grey aluminum finish

## POLYCARBONATE PANEL

- Milky white finish

## METAL-CLAD WOOD SOFFIT

- Wood species to match beige brick



POLYCARBONATE PANEL



IRONSPOT BRICK



BEIGE BRICK



METAL PANEL



WOOD SOFFIT



EXISTING BRICK



**Tecton**  
ARCHITECTS

# LATIMER LANE SCHOOL

*STATE PROJECT NO. 128-0111 RNV*

DESIGN REVIEW BOARD MEETING

FEBRUARY 7, 2022