

# Town of Simsbury

Office of Community Planning and Development - Zoning Commission Application

DATE: 4/9/2021 FEE: \$ 240 CK #: 382 APP #: 21-0607

PROPERTY ADDRESS: 731 Hopmeadow Street Simsbury, CT 06070

NAME OF OWNER: Simsbury 1820 House

MAILING ADDRESS: 731 Hopmeadow Street

EMAIL ADDRESS: chris@somagrille.com TELEPHONE # 860-217-0937

NAME OF AGENT: Christopher Riley

MAILING ADDRESS: 731 Hopmeadow Street Simsbury, CT 06070

EMAIL ADDRESS: chris@somagrille.com TELEPHONE # 860-538-0326

ZONING DISTRICT: \_\_\_\_\_ LOT AREA: \_\_\_\_\_ SQ FT/ACRES

Does this site have wetlands?  YES  NO Have you applied for a wetlands permit?  YES  NO

**REQUESTED ACTION (PLEASE CHECK APPROPRIATE BOX):**

- ZONE CHANGE:** The applicant hereby requests that said premises be changed from zone \_\_\_\_\_ to zone \_\_\_\_\_.
- TEXT AMENDMENT:** Please attach proposed changes, including Articles and Sections, and purposes.
- SPECIAL EXCEPTION:** The applicant hereby requests a public hearing pursuant to Article \_\_\_\_\_, Section \_\_\_\_\_.
- SITE PLAN APPROVAL:** The applicant hereby requests
  - PRELIMINARY  FINAL  SITE PLAN AMENDMENT pursuant to Article 5, Section 1
  - SIGN PERMIT
  - OTHER (PLEASE EXPLAIN): \_\_\_\_\_

*NOTE: Each application must fully comply with the requirements of the Zoning Regulations prior to receipt by the Commission. Each application for zone change and/or special exception shall include a list of names and addresses of abutting property owners and all property owners within 100 feet of the subject site.*

A check payable to the Town of Simsbury must accompany this original signed and dated application. Six (6) complete (folded) sets of plans and eleven (11) copies of the completed application and correspondence must also be included. If you have a PDF of your plans, we would appreciate a copy of that sent to [lvarkovyski@simsbury-ct.gov](mailto:lvarkovyski@simsbury-ct.gov), as well.

Signature of Owner: Judy T. Bales Date: 4.12.21

Signature of Agent: [Signature] Date: 4/12/2021

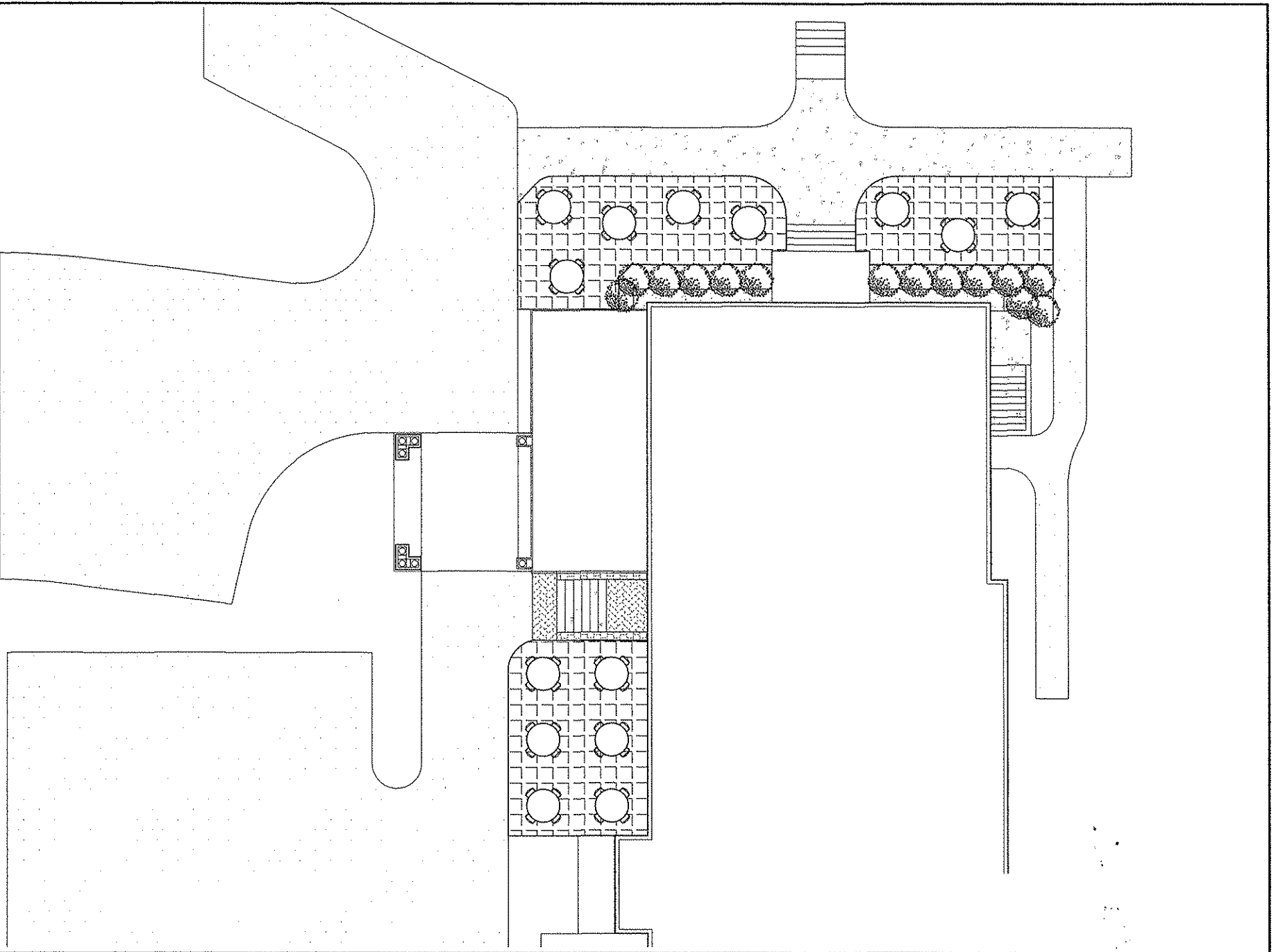

**L.1**

Sheet No.  
 Project:  
 731 Hopmeadow Street  
 Simsbury, CT 06070  
 Telephone: (860) 872-7932  
 Fax: (860) 872-7933  
 www.landscapeinc.com



Scale:  
 1" = 3'  
 0' 2.5" 5' 7.5" 10' 15'  
 Date: 20 March 2021  
 Revisions:

Project:  
**SOMA GRILL**  
**The Simsbury 1820 House**  
 731 Hopmeadow Street, Simsbury, CT 06070

Project:  
**Proposed Outdoor Dining**  
 731 Hopmeadow Street, Simsbury, CT  
**LANDSCAPE & LIGHTING PLAN**



Sheet No. 1.1  
 Drawing by: [Signature]  
 Date: 20 March 2021



Scale: 1" = 5'  
 0 2.5 5 7.5 10 15  
 Date: 20 March 2021

**SOMA GRILL**  
 The Simsbury 1820 House  
 731 Hammond Street, Simsbury, CT 06070

Proposed Outdoor Dining  
 LANDSCAPE &  
 PLANNING, INC.

