



Town of Simsbury

933 HOPMEADOW STREET

SIMSBURY, CONNECTICUT 06070

Office of Planning and Community Development

To: Simsbury Conservation Commission/Inland Wetlands Agency
From: Brittany MacGilpin, Assistant Town Planner
Date: August 15, 2023
RE: CC 23-28, 38 Long View Drive

Summary of Request

James Lewis, owner and applicant, has submitted an application for a wetlands permit to dredge +/- 1,000 sq. ft. of the pond on the property for its regular maintenance at 38 Long View Drive, (Assessor's Map C13, Block 301, Lot 020) Simsbury, CT 06070, zone R-40.

This application was received at the July 18, 2023 meeting and determined non-significant. The property received a previous wetlands approval in 1991 for similar type maintenance of the pond, which you can find as attachment 'A' of this report.



Project Description

According to a Town staff report in 1991, the pond was originally dug in 1981 after receiving a permit from the Conservation Commission. The pond is in a flat area on the edge of a 55-acre wood wetland, part of the Stratton Brook network. The report also states that it is fed by a high-water table as well as the brook. The surrounding wetland soils consists of Saco silt loam (SbA), which is categorized as a very poorly drained floodplain type soil.

The property owner has contracted with Kare Construction to perform the dredging work with the use of an excavator. The maintenance includes removal of sand, silt and some vegetation on the south side of the pond. Approximately 70 cubic yards of sand comprising roughly 4% of the total area of the pond will be removed.

Telephone (860) 658-3245
Facsimile (860) 658-3206

An Equal Opportunity Employer
www.simsbury-ct.gov

8:30 - 7:00 Monday
8:30 - 4:30 Tuesday through Thursday
8:30 - 1:00 Friday

According to the applicant, the primary area of activity is the south entrance to the pond where a 6' deep by 6' wide forebay and another trench of the same size inside the immediate entrance of the pond.

The contractor will access the pond by the owner's driveway. The application states that the lawn and surrounding areas will be regraded and restored to original condition after completion.

Soil and Erosion controls include haybales downstream and silt fencing around the stock pile and equipment area as seen below. The equipment area is shown on the map with black hatch marks.

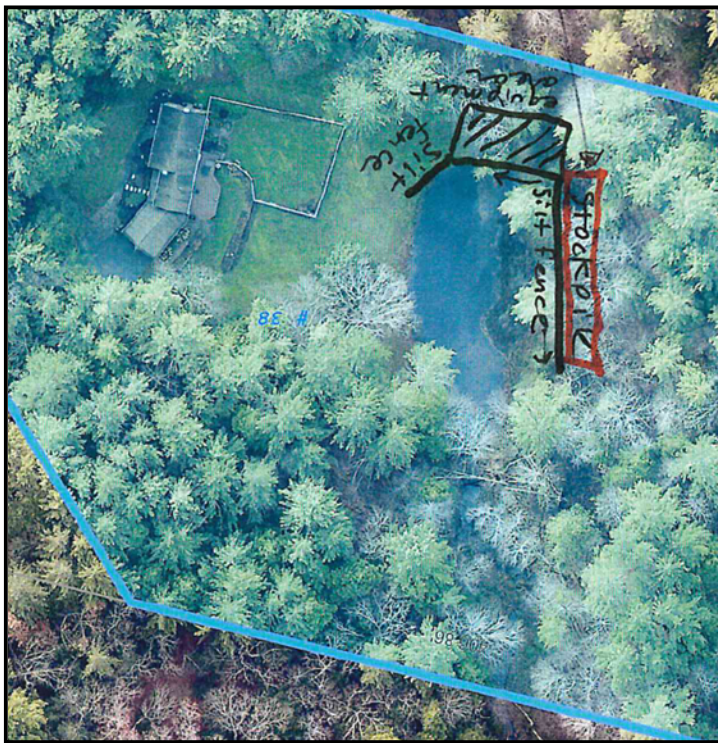
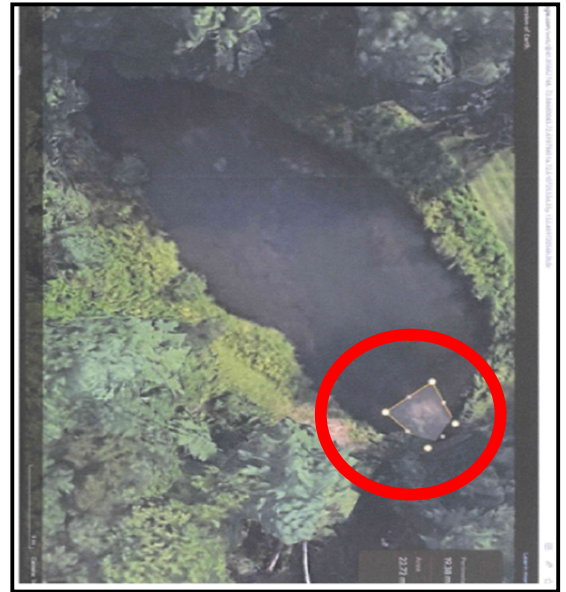

There was discussion with the commission at the July 18, 2023 meeting regarding the 6-foot buffer surrounding a portion of the pond. The commission suggested a 15-foot planting buffer surrounding the pond to better protect the slope and siltation from entering the pond including any fertilizer used.

Per Section 6 – Regulated Activities to be Licensed, the proposed removal of material within a watercourse as described in the application is a **regulated activity**. The Inland Wetlands Agency found this activity to be non-significant.

Draft Motions

Moved, the Conservation Commission **APPROVES Application CC #23-28** of 38 Long View Drive, LLC, Owner, James Lewis, Applicant, for a wetland permit to dredge +/-1,000 sq. ft. of the pond on the property for regular maintenance of the pond at 38 Long View Drive, (Assessor's Map C13, Block 301, Lot 020) Simsbury, CT 06070, zone R-40, based upon the following findings:

- a. Short-term impacts from the proposed activity will be controlled by installation and maintenance of erosion and sediment controls.
- b. The disturbed access areas of the project will be restored to the original condition once the project is complete.

And subject to the following conditions:

1. The project shall be implemented in conformance with the submitted application, dated June 29, 2023.
2. Native plantings will be used for replanting and invasive species removed to the greatest extent possible.
3. At all times during site work and until soil areas are stabilized, the applicant shall install and maintain erosion and sediment control measures depicted in the application or other measures deemed necessary by the Commission's agent to prevent erosion and sedimentation impacts to the watercourse.
4. All erosion control and soil stabilization measures shall comply with the approved plans and the guidelines as established in the Connecticut Guidelines for Soil Erosion and Sediment Control, 2002, CTDEP Bulletin 34.
5. Upon direction of the Commission's agent, erosion and sediment control measures shall be removed by the applicant following stabilization of the site.
6. The Inland Wetlands Agent shall be notified at least 48 hours prior to commencement of activities.

Or

Moved, (An alternative Motion)



**CONSERVATION COMMISSION
INLAND WETLANDS AND WATERCOURSES AGENCY**

SIMSBURY, CONNECTICUT 06070

July 26, 1991

John R. and Catherine Milligan
38 Longview Drive
Simsbury, CT 06070

Dear Mr. and Mrs. Milligan:

RE: Inland Wetlands Permit No. 91/16
38 Longview Drive

The Conservation Commission, acting as the Inland Wetlands and Watercourses Agency for the Town of Simsbury, reviewed your application at its meeting of July 16. After discussion, the Commission voted the following action:

That the work described in the application for wetlands permit is a regulated activity in that it involves removal of material from a pond.

That the work described in the application for wetlands permit is a significant activity because of the amount of material that will be removed.

To not hold a public hearing.

To grant a permit to remove deposits of sand from and restore a pond on property at 38 Longview Drive as described in the application of John and Catherine Milligan with following conditions: Compliance with Staff Comments in the Staff Report dated June 18, 1991 and notification to the Conservation Officer at least three working days prior to the work commencing. Staff requested on July 2, 1991, that the work not start until after August 12, 1991 (Mr. Milligan did not have any objections to this request when he was present before the Commission on April 2).

The permit is granted because the removal of sediments will improve the health of the pond and in particular its natural capacity to support wildlife. In addition, it will enhance the overall Stratton Brook wetland system.

John and Catherine Milligan
July 26, 1991
Page 2

The term of the permit is for one year commencing on the date of this letter.
An extension of one year may be granted upon request.

Sincerely,

A handwritten signature in cursive script that reads "M. Howard Beach". The signature is written in dark ink and is positioned below the word "Sincerely,".

M. Howard Beach, Chairman
Conservation Commission/Inland Wetlands and Watercourses Agency
CC: Town Clerk
Certified Mail No.: P 373 415 703

STAFF REPORT - June 18, 1991

PROJECT NAME: Milligan Pond Dredging
LOCATION: 38 Longview Drive
APPLICANT: John R. and Catherine Milligan
NO: 91/16-IW

Project Description

The pond was originally dug in 1981 after the Conservation Commission granted a permit. Reasons given were that: "It will enhance the environmental aspects of the area and that it is an excellent site for a wildlife pond." (CC - May 5, 1981, Meeting Minutes - page 4). The original permit application is not readily available for review of the design. However, it appears that the brook and a high groundwater table supply the pond. There is no dam involved. Currently, the pond is full of sediment which the applicant would like to remove.

The pond is located in a flat area on the edge of a 55-acre wooded wetland which is bounded on its western edge by Town Forest Road. This wetland is part of the Stratton Brook network. The 6-8' wide brook is a tributary to Stratton Brook. The west side of the pond is bounded by 20' of lawn. Beyond this is wetland vegetation consisting of skunk cabbage and red maple. The wetlands soil type is Saco silt loam (SbA) which is a very poorly drained floodplain soil type.

Staff Comments

1. Because of the lack of dam, the brook flow will have to be pumped around the pond during excavation.
2. Rows of haybales downstream will be critical to keep sedimentation from moving downstream.
3. Equipment access will need to be carefully monitored in order to prevent damage to the septic system and slope.
4. The work should be performed during a dry time of year.
5. The Commission needs to discuss where the dredged material will be placed. A limited amount could go on the west lawn area but further incursion into the wetlands is not recommended. Similarly, the lawn area on the east side of the pond could take some of the spoils. All areas would need to be seeded and have appropriate erosion controls. If the sediment were removed from the site, a dewatering area would still have to be established.