

# Town of Simsbury



Office of Community Planning and Development - Zoning Commission Application

DATE: 07/12/2021 FEE: \$ 240 CK #: APP #:

PROPERTY ADDRESS: 200 Hopmeadow Street, Simsbury, CT 06070

NAME OF OWNER: SL Simsbury LLC

MAILING ADDRESS: 195 Morristown Road, Basking Ridge, NJ 07920

EMAIL ADDRESS: DanLacz@Silvermangroup.Net TELEPHONE # (973) 765-0100

NAME OF AGENT: T.J. Donohue, Jr., Killian & Donohue, LLC

MAILING ADDRESS: 363 Main Street, Hartford, CT 06106

EMAIL ADDRESS: tj@kdjlw.com TELEPHONE # (860) 560-1977

ZONING DISTRICT: HFBC LOT AREA: 40 SQM/AORES

Does this site have wetlands?  YES  NO Have you applied for a wetlands permit?  YES  NO

**REQUESTED ACTION (PLEASE CHECK APPROPRIATE BOX):**

**ZONE CHANGE:** The applicant hereby requests that said premises be changed from zone \_\_\_\_\_ to zone \_\_\_\_\_

**TEXT AMENDMENT:** Please attach proposed changes, including Articles and Sections, and purposes.

**SPECIAL EXCEPTION:** The applicant hereby requests a public hearing pursuant to Article \_\_\_\_\_, Section \_\_\_\_\_.

**SITE PLAN APPROVAL:** The applicant hereby requests \_\_\_\_\_

**PRELIMINARY**  **FINAL**  **SITE PLAN AMENDMENT** pursuant to Article 5, Section J

**SIGN PERMIT**

**OTHER (PLEASE EXPLAIN):** Change in Site Plan to create 23 additional parking spaces adjacent to apartment AP-1A.

**SEE PLAN ATTACHED.** [Approve Road Use for Emergency Fire Access to River].

**NOTE:** Each application must fully comply with the requirements of the Zoning Regulations prior to receipt by the Commission. Each application for zone change and/or special exception shall include a list of names and addresses of abutting property owners and all property owners within 100 feet of the subject site.

A check payable to the Town of Simsbury must accompany this original signed and dated application. Six (6) complete (folded) sets of plans and eleven (11) copies of the completed application and correspondence must also be included. If you have a PDF of your plans, we would appreciate a copy of that sent to [cvlben@simsbury-ct.gov](mailto:cvlben@simsbury-ct.gov), as well.

Dan Lacz  
Signature of Owner  
Authorized Agent

7/13/21  
Date

T.J. Donohue, Jr.  
Signature of Agent

7-13-21  
Date

Telephone (860) 658-3245  
Facsimile (860) 658-3206

[www.simsbury-ct.gov](http://www.simsbury-ct.gov)

933 Hopmeadow Street  
Simsbury, CT 06070





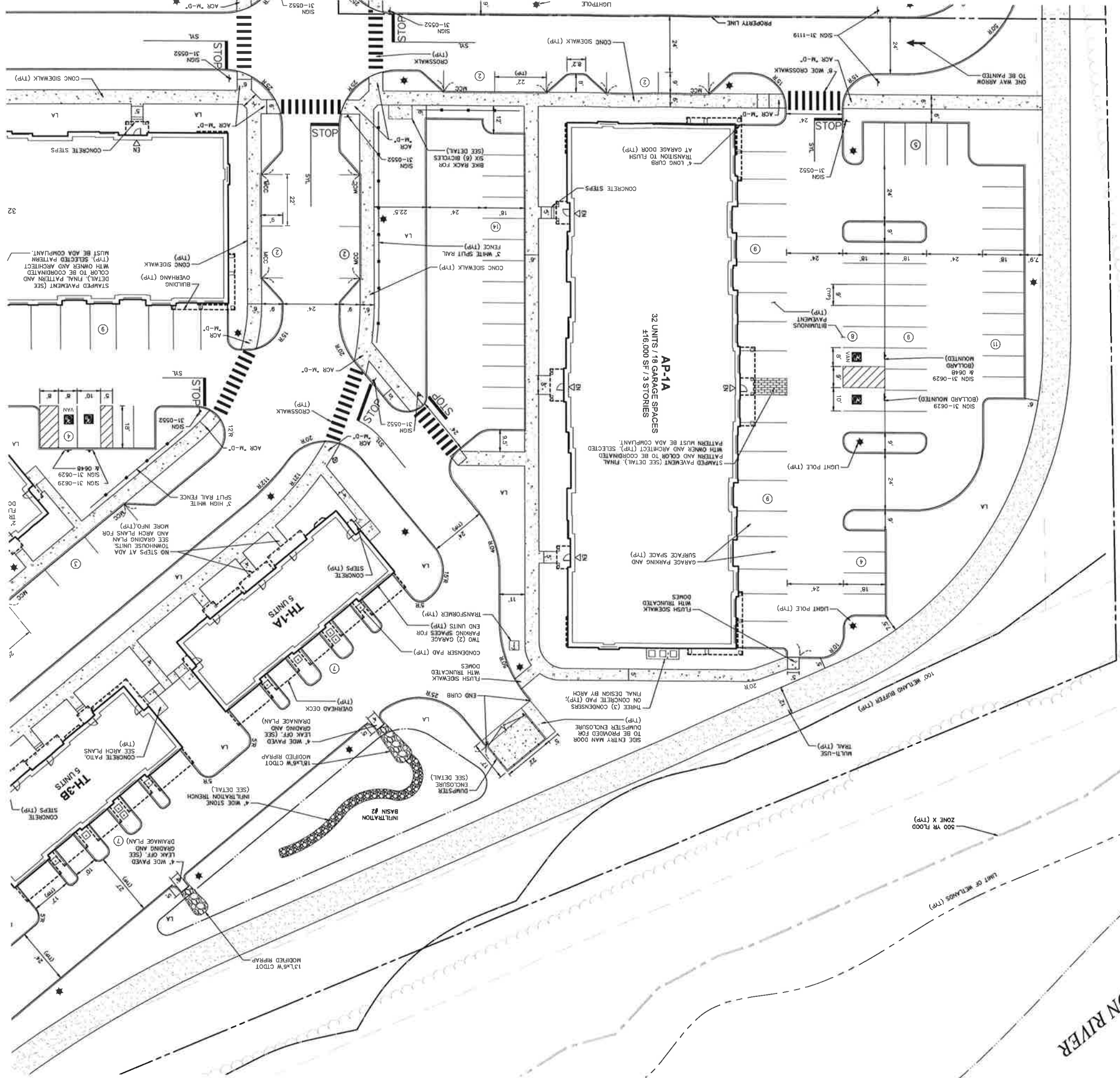

KEY PLAN

1	2	3
4	5	6
7	8	9
10	11	

**The Siverman Group**  
 SL Simsbury, LLC  
 788 Morris Turnpike  
 Short Hills, NJ 07078

**vhb**  
 vhb.com  
 100 Great Meadow Road  
 Suite 200  
 Wethersfield, CT 06109  
 860.807.4300

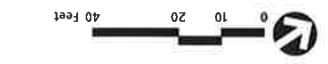

**The Ridge at Talcott Mountain**  
 200 Hopmeadow Street  
 Simsbury, Connecticut

Construction

Rev	Description	Date
1	TOWN COMMENTS PROGRESS PRINT	5/10/17
2	50% STEP 2 COMMENTS	7/10/17
3	INTERNAL FINAL PLANS	9/6/17
4	WPCA SUBMISSION	9/15/17
5	WPCA SUBMISSION	10/3/17
6	CONSTRUCTION	11/10/17
7	CLUB HOUSE FOOTPRINT	5/14/18
8	CLUB HOUSE AMENITY DESIGN	12/14/18
9	SITE PLAN MODIFICATION	3/22/21

Checked By: \_\_\_\_\_  
 Date: \_\_\_\_\_  
 March 27, 2017

**Layout and Materials Plan 7**

