

REV.	DATE	DESCRIPTION OF REVISION	APPR.
1	2/24/2023		

VEHICLE TURNING DEMONSTRATION
E-ONE 100-FT AERIAL TRUCK
VESSEL MULTI-FAMILY HOUSING
PROPERTY ADDRESS
446 HOPMEADOW STREET, SIMSBURY, CT 06089
PREPARED FOR
VESSEL TECHNOLOGIES, INC.
46 WEST 55TH STREET, NEW YORK, NY 10019

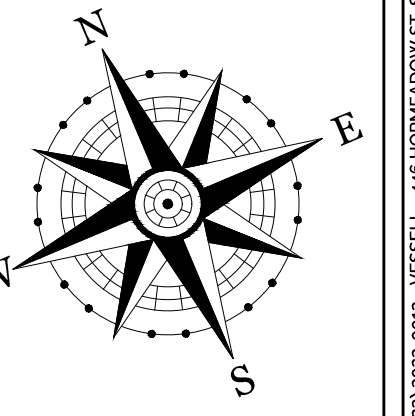

PROJECT NO. 2022-0013	SCALE 1" = 20'
DRAWN BY: SMM	DATE 2/24/2023
CHECKED BY: SMM	DATE 2/24/2023

DRAWING
TD-1
SHEET NUMBER: 1 OF 1

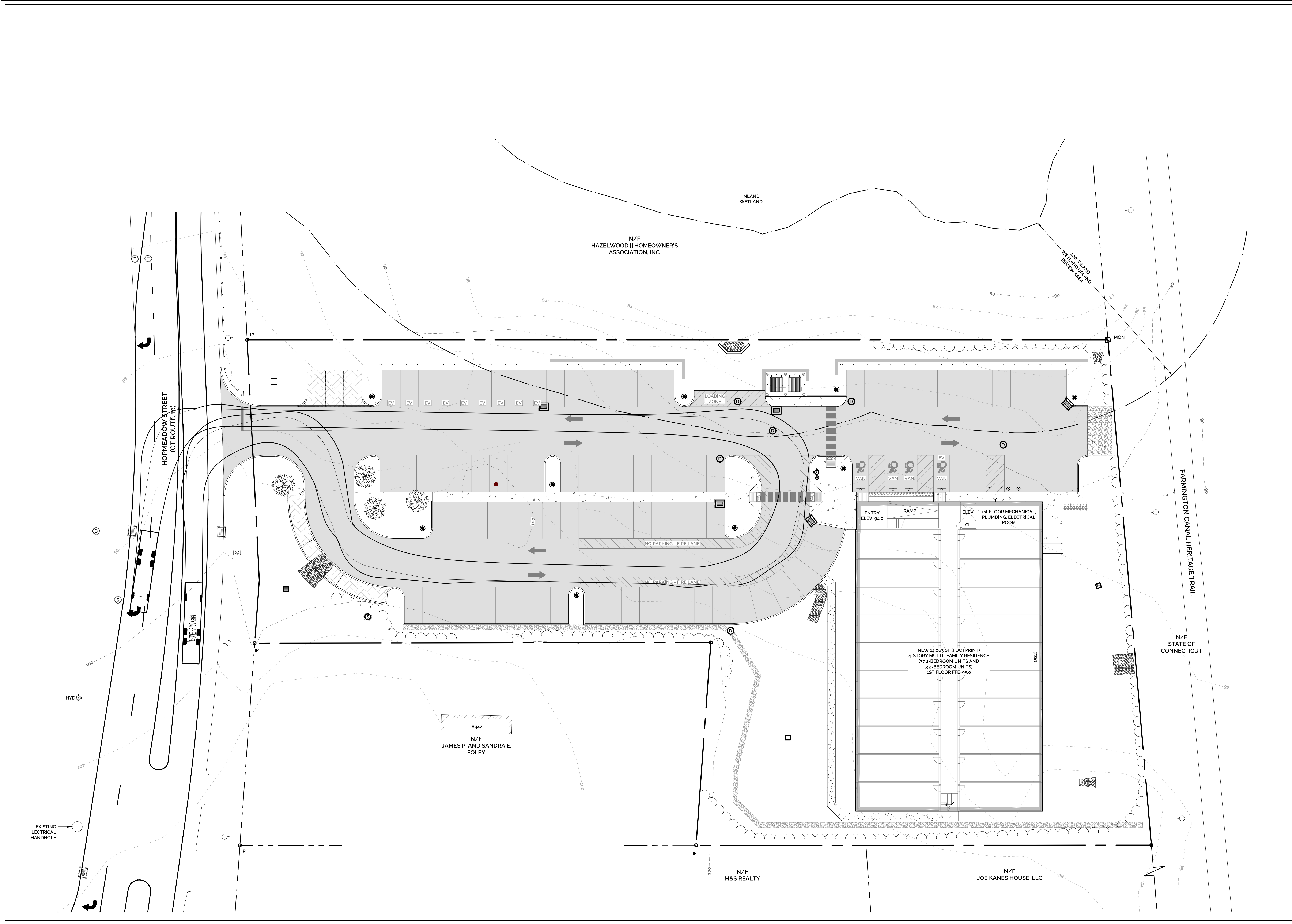

Z:\SIMSBURY\ENGINEERING ASSOCIATES\PROJECTS\2022\2022-0013 - VESSEL - 446 HOPMEADOW ST SIMSBURY\DWGS\VEHICLE TURNING\LANDING TAB - TURNING ROAD E-ONE FIRE SERVICE 2/24/2023 12:11 PM Plotter: 2/24/2023 12:18 PM